



SPECIFICATIONS

Rated Current:1.5AMP
 Contact Resistance:20mΩ Max
 Withstand Voltage:500V AC/DC
 Insulation Resistance:1000MΩ Min
 Operation Temperature:-40°c to +105°c

Contact Material:Brass
 Contact Plating:Au or Sn Over Ni
 Insulator Material:Polyester(UL94V-0)
 Standard: PA6T
 Max.Processing Temp: 230°C for 30-60 seconds
 (260°C for 5 seconds)

Recommended P.C.B Layout(Top Side)
 (PCB BOARD TOLERANCE±0.05)

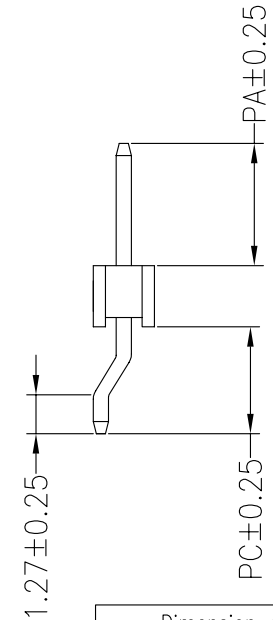
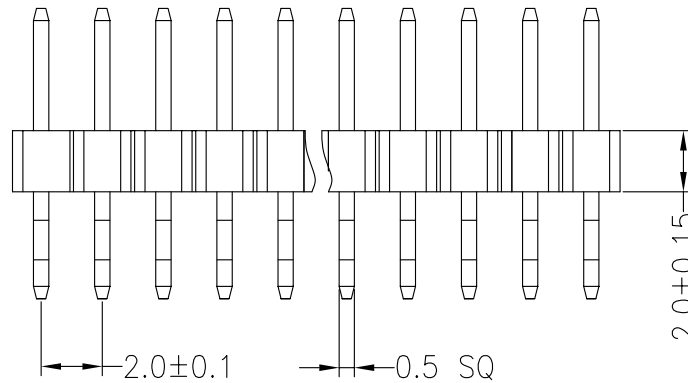
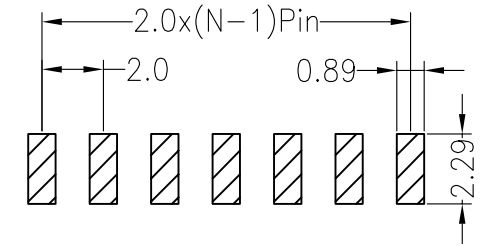
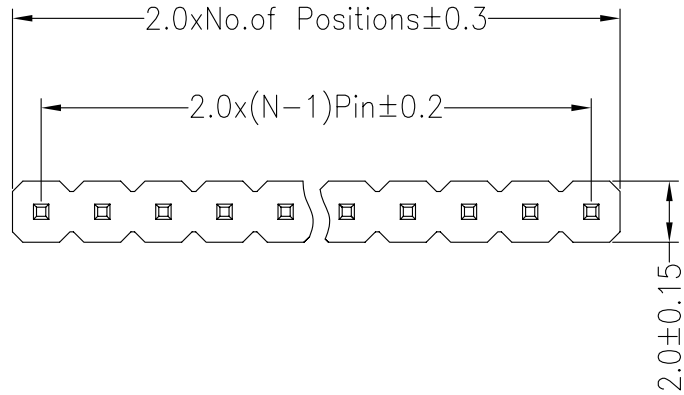

Dimension antitheses list			
ITEM	PA	PC	L
Standard	4.00	2.80	9.00
Alternate			

				OPERATION		DRAW	YiYuSheng	12.04.11	SCALE	FIT	CONN THERM		
				X.X	±0.30				UNIT	mm			
				X.XX	±0.20	CHECK		SIZE	A4	PART NO. PLMTSxxR-JL			
				X.XXX	±0.10	APPROVE		SHEET	1/1				
A0	2012.04.11	NEW DRAWING		Angle	±3°			PROJ.	◆	TITLE:	2.0PH 1xNPin H2.0 90° SMT		
REV	DATE	MODIFICATION DESCRIPTION		DIM	TOL	CHANGE							