

DETAILS

| | |
|------------------------|------------------|
| Product Number | C10892_GT3-M |
| Family | Gt3 |
| Type | Lens array |
| Color | clear |
| Diameter | 35 mm |
| Height | 9 mm |
| Style | round |
| Optic Material | PMMA |
| Holder Material | |
| Fastening | pin, glue |
| Status | production ready |
| ROHS Compliant | Yes |
| Date Updated | 10/11/2014 |



OPTICAL PROPERTIES

| LED | Viewing Angle | Light Beam | Efficiency | cd/lm | Connector |
|---------------------|---------------|------------|------------|-------|-----------|
| XP-E | 27 deg | Medium | 91 % | 2.710 | - |
| XP-G | 34 deg | Medium | 92 % | 1.840 | - |
| XB-D | 25 deg | Medium | 91 % | 2.000 | - |
| LUXEON Rebel | 28 deg | Medium | 89 % | - | - |
| LUXEON Rebel ES | 32 deg | Medium | 86 % | - | - |
| LUXEON A | 32 deg | Medium | - | - | - |
| NCSxx19A | 28 deg | Medium | 88 % | - | - |
| NVSxx19A | 34 deg | Medium | 88 % | - | - |
| Oslon SSL 80 | 28 deg | Medium | 92 % | - | - |
| Oslon SSL 150 | 26 deg | Medium | 86 % | 2.480 | - |
| Oslon Square EC | 32 deg | Medium | 88 % | 2.020 | - |
| Z5 | 28 deg | Medium | - | - | - |
| Double Dome (GM2BB) | 30 deg | Medium | - | - | - |

Relative intensity of C10892_GT3-M-XBD

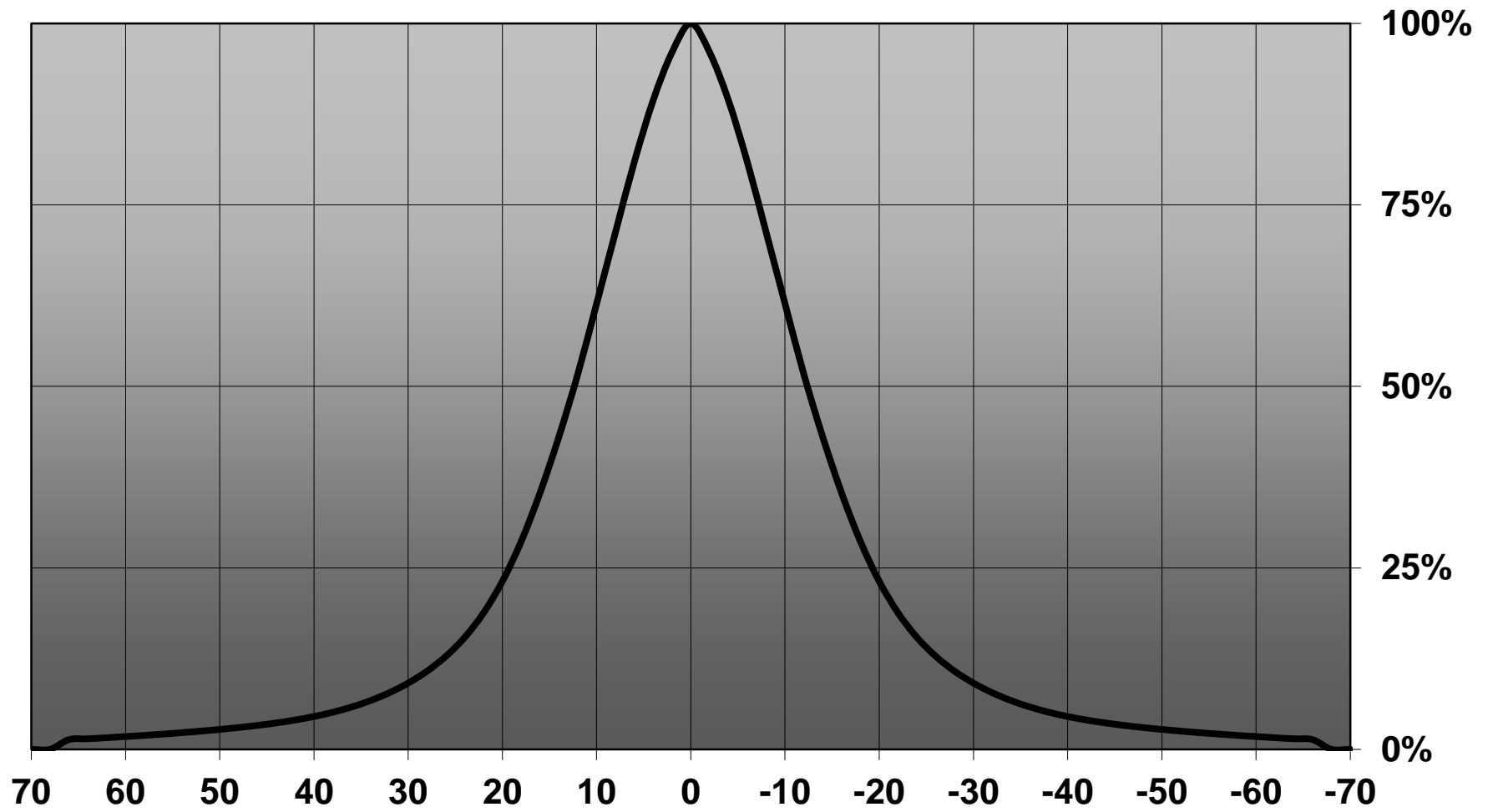

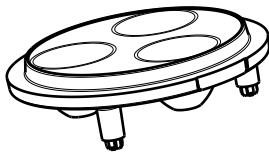

Isometric view
Scale: 1:1

Material: PMMA

Part no.s:

- C10891_GT3-XP-S
- C10891_GT3-XP-G-S
- C10891_GT3-OSL-S
- C10891_GT3-DD-S
- C10891_GT3-RE-ES-M
- C10891_GT3-Z5-S
- C10892_GT3-XP-M
- C10892_GT3-XP-G-M
- C10892_GT3-OSL-M
- C10892_GT3-DD-M
- C10892_GT3-XP-M
- C10892_GT3-Z5-M
- C10893_GT3-XP-W
- C10893_GT3-XP-G-W
- C10893_GT3-OSL-W
- C10893_GT3-DD-W
- C10893_GT3-RE-ES-W
- C11623_GT3-RE-VW
- C11623_GT3-N19-VW
- C11624_GT3-XP-VW
- C11624_GT3-XP-G-VW
- C11624_GT3-OSL-VW
- C11624_GT3-DD-VW
- C11624_GT3-Z5-VW

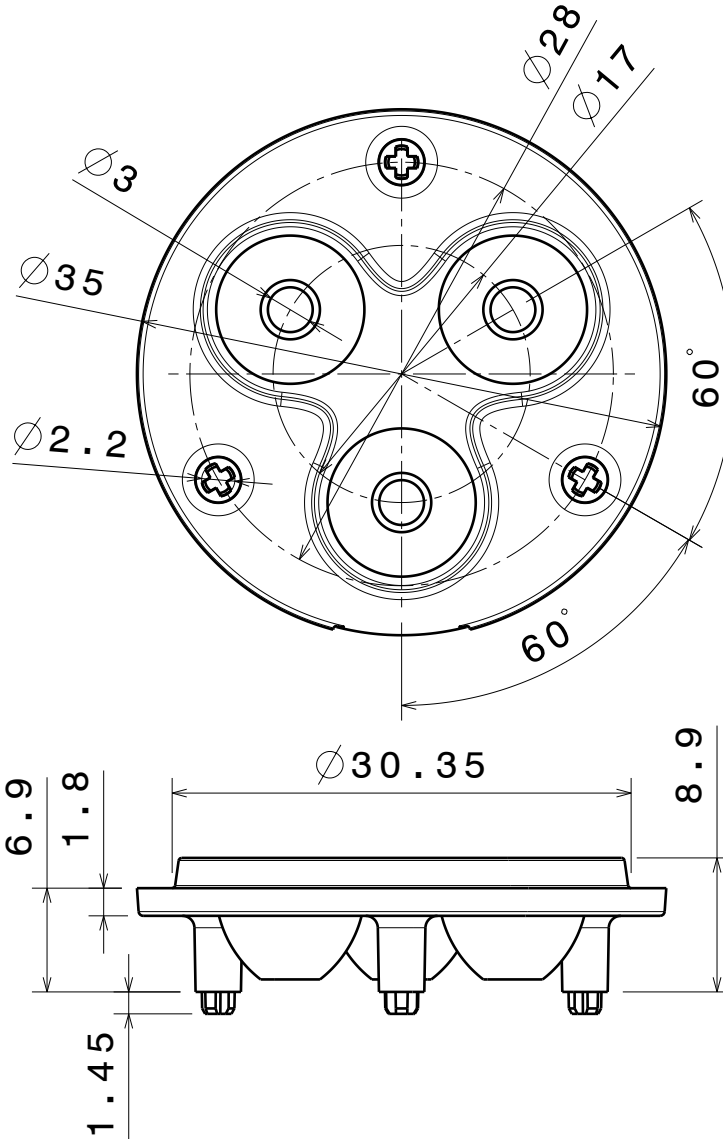

Bottom view

Front view

This drawing is our property.
It can't be reproduced
or communicated without
our written agreement.



L
T
F
F

e
e
i
i
N
n

d

DRAWING TITLE

Datasheet GT3-Series Lens

| | | | | | | | |
|-------------------|--|--------------------|--|--|---------------------|--------------|----------|
| DRAWN BY p | | DATE 08.01.2010 | | DRAWING TITLE Datasheet GT3-Series Lens | | | |
| CHECKED BY t k | | DATE 07.01.2010 | | SIZE A4 | DRAWING NUMBER - | | REV 1 |
| DESIGNED BY hh | | DATE 07.01.2010 | | SCALE 2:1 | WEIGHT (g) | SHEET 1/1 | |

D

A

Ledil Oy C10892_GT3-XP-G-M C10892_GT3-XP-G-M / LDC (Linear)

Luminaire: Ledil Oy C10892_GT3-XP-G-M C10892_GT3-XP-G-M
Lamps: 3 x Cree XP-G (White)

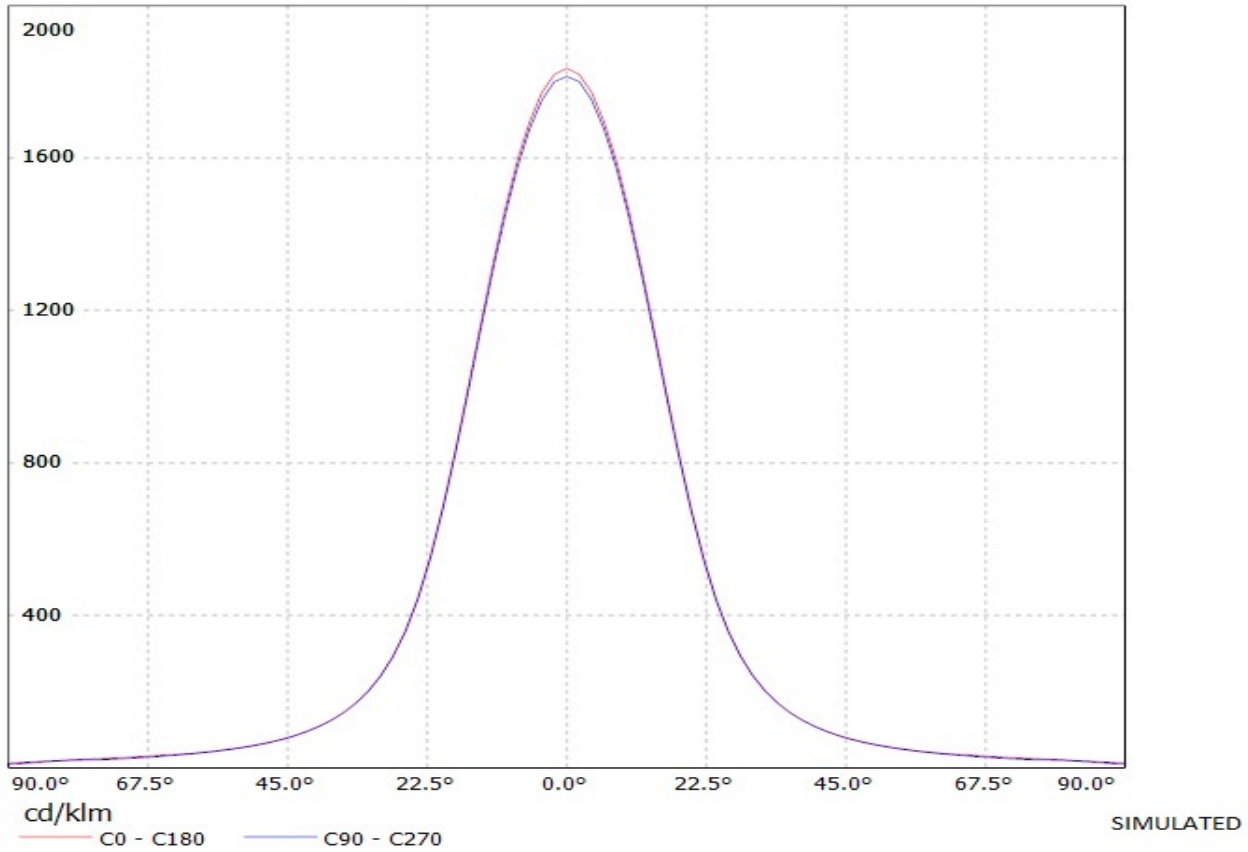

Luminaire: Ledil oy C10892_GT3-M-OSL150 (Osram Oslon 150 deg 266lm @ 250mA)
Lamps: 1 x Osram Oslon 150 deg 266lm @ 250mA

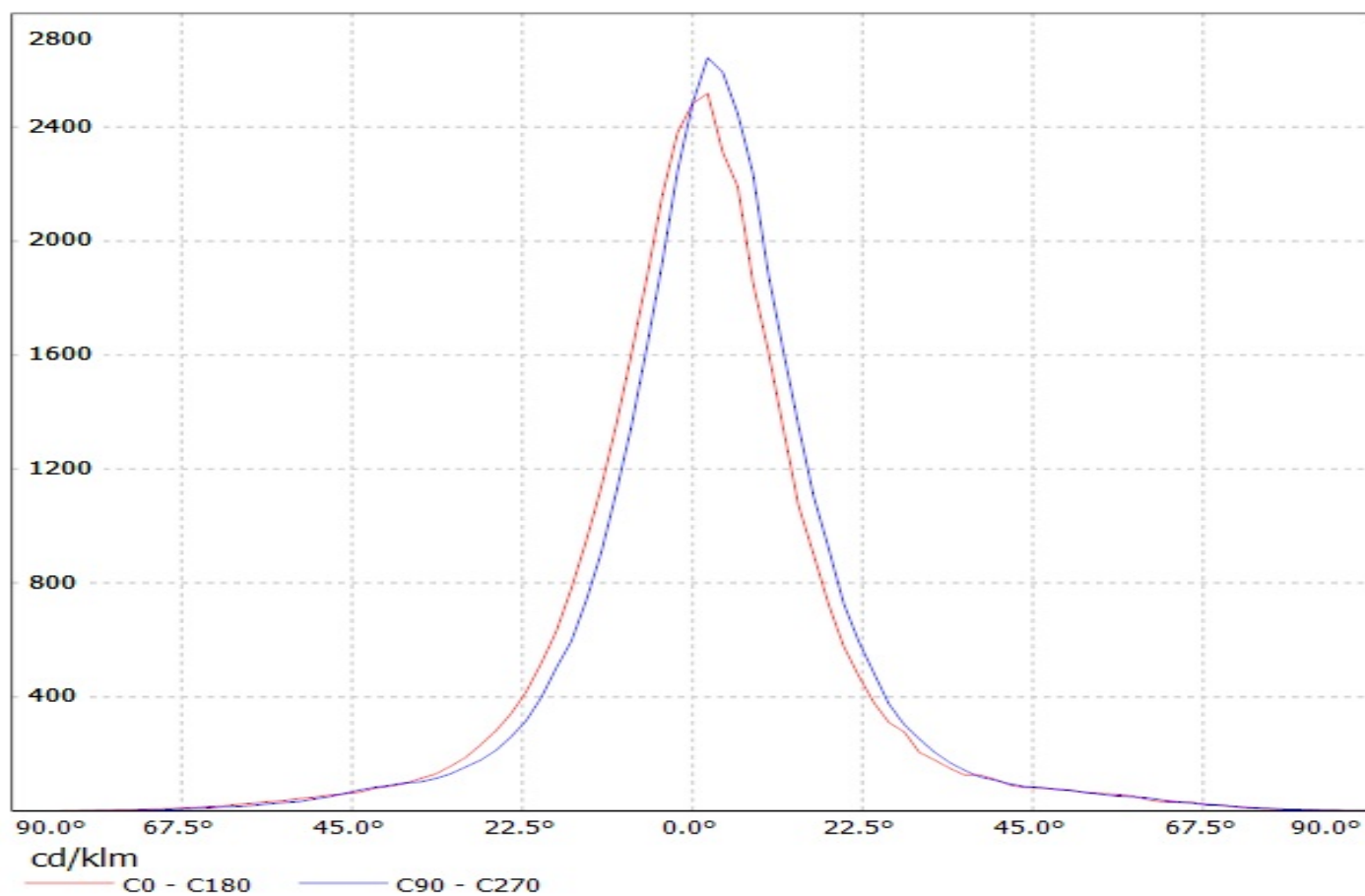

Ledil Oy C10892_GT3-XP-G-M C10892_GT3-XP-G-M / LDC (Polar)

Luminaire: Ledil Oy C10892_GT3-XP-G-M C10892_GT3-XP-G-M

Lamps: 3 x Cree XP-G (White)

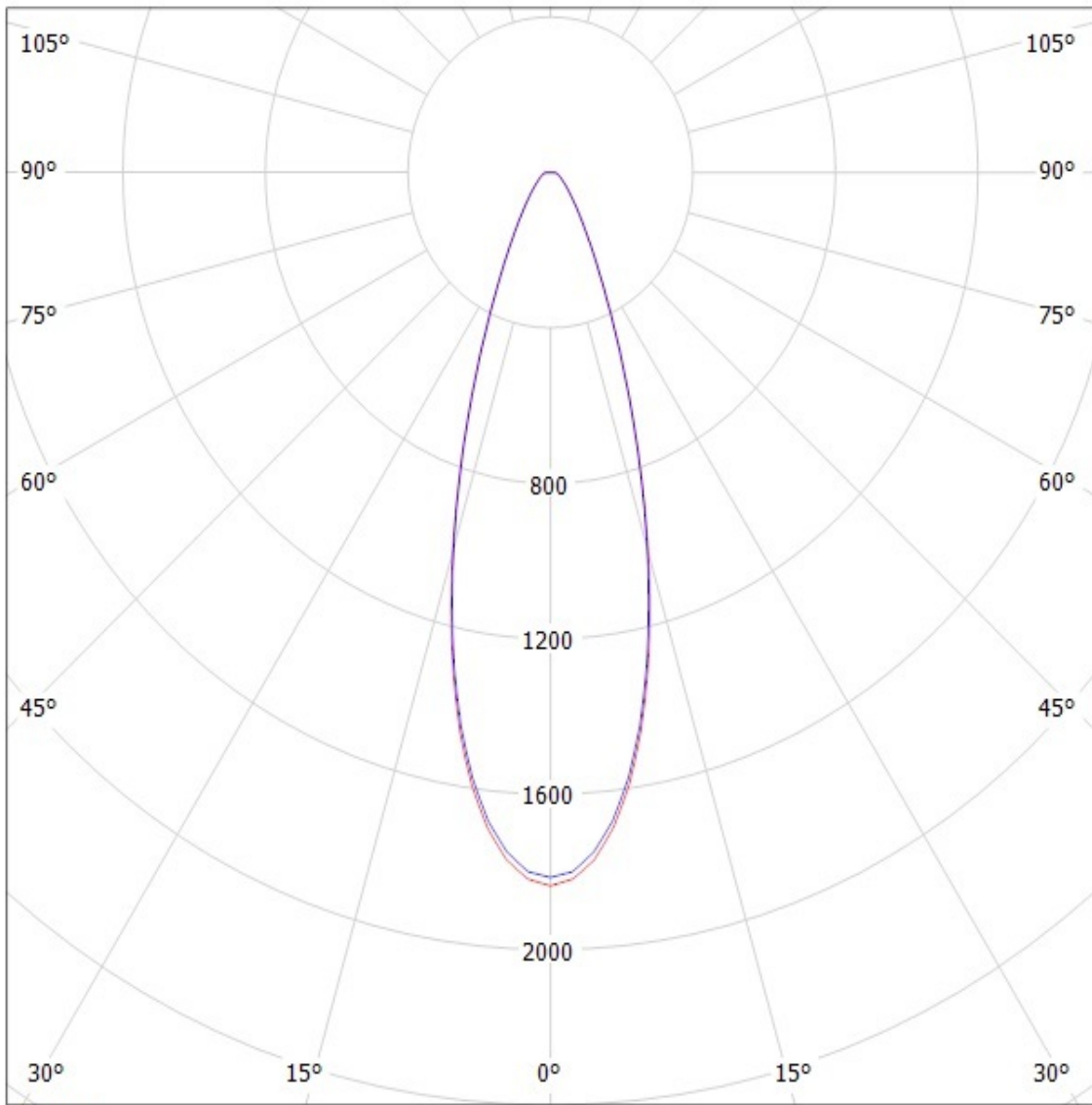

cd/klm

— C0 - C180

— C90 - C270

SIMULATED

Luminaire: Ledil oy C10892_GT3-M-OSL150 (Osram Oslon 150 deg 266lm @ 250mA)
Lamps: 1 x Osram Oslon 150 deg 266lm @ 250mA

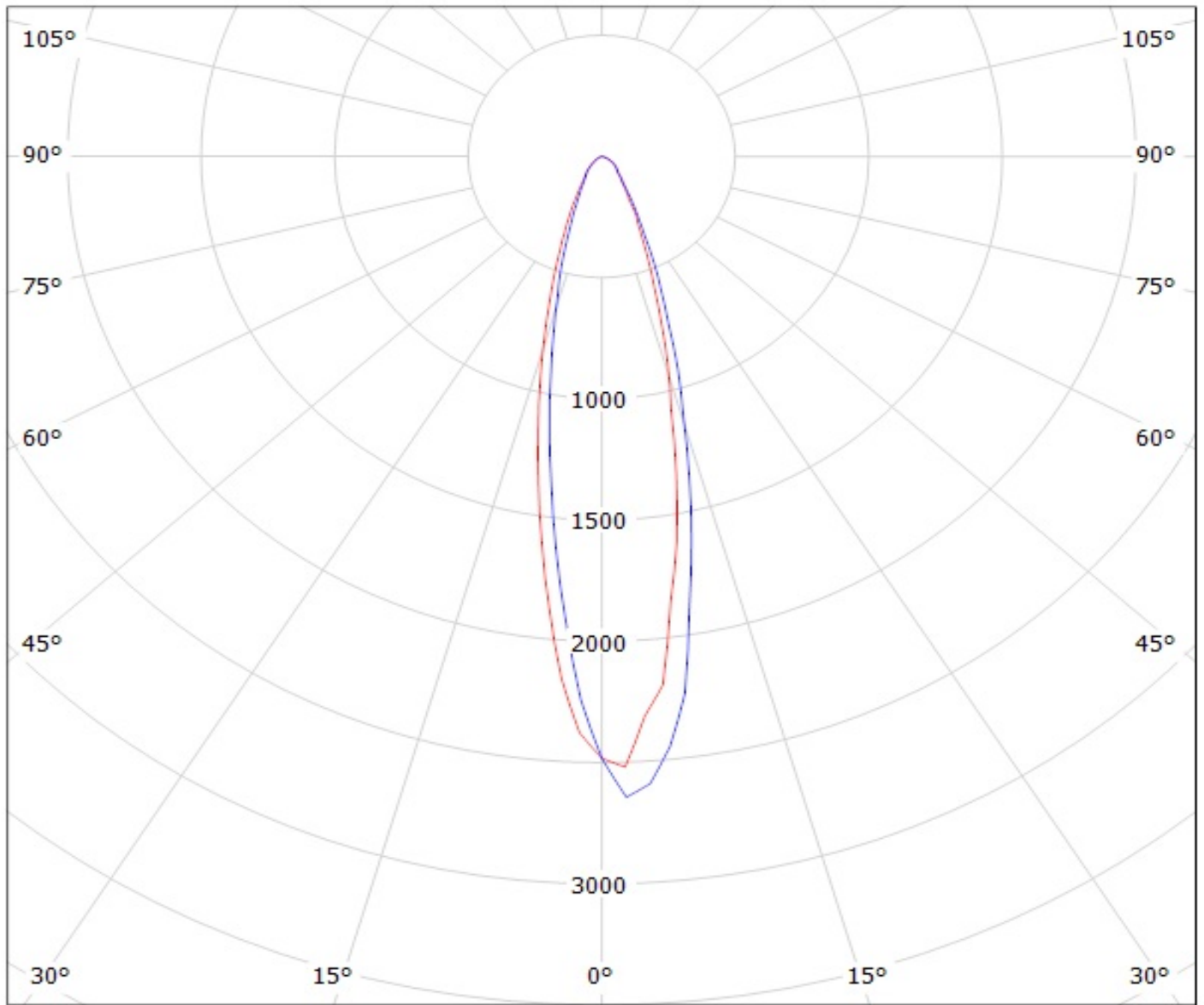

cd/klm

— C0 - C180

— C90 - C270

NOTE: The typical divergence will be changed by different color, chip size and chip position tolerance. The typical total divergence is the full angle measured where the luminous intensity is half of the peak value.