

Data Sheet

LL01CR-WIxxL02-Mx



Xlamp XM-L AWT



■ Features & Typical Applications

- High efficiency
- Available in 3 beam Patterns
- Optimized for uniform effects
- Lens with Housing
- Decorative Light
- Architectural Lighting
- Down Light

■ Table of Contents

General Information & Product Nomenclature.....	P.2
Optical Specifications	P.3
Mechanical Specifications	P.4
Package Specifications	P.5

LL01CR-WIxxL02-Mx

General Information

- Lens Material Optical Grade PC
- Operating Temperature range -40°C~+110°C(upper limit +120°C)
- Storage Temperature range -40°C~+110°C(upper limit +120°C)
 - * Average transmittance in visible spectrum 400nm~700nm>90%
- Usage and Maintenance:
 1. If necessary, clean lenses with mild soap, water and soft cloth.
 2. Never use any commercial cleaning solvents on lenses, like alcohol.
 3. Please handle or install lenses with wearing gloves, skin oils may damage lens or its optical characteristic.

Product Nomenclature

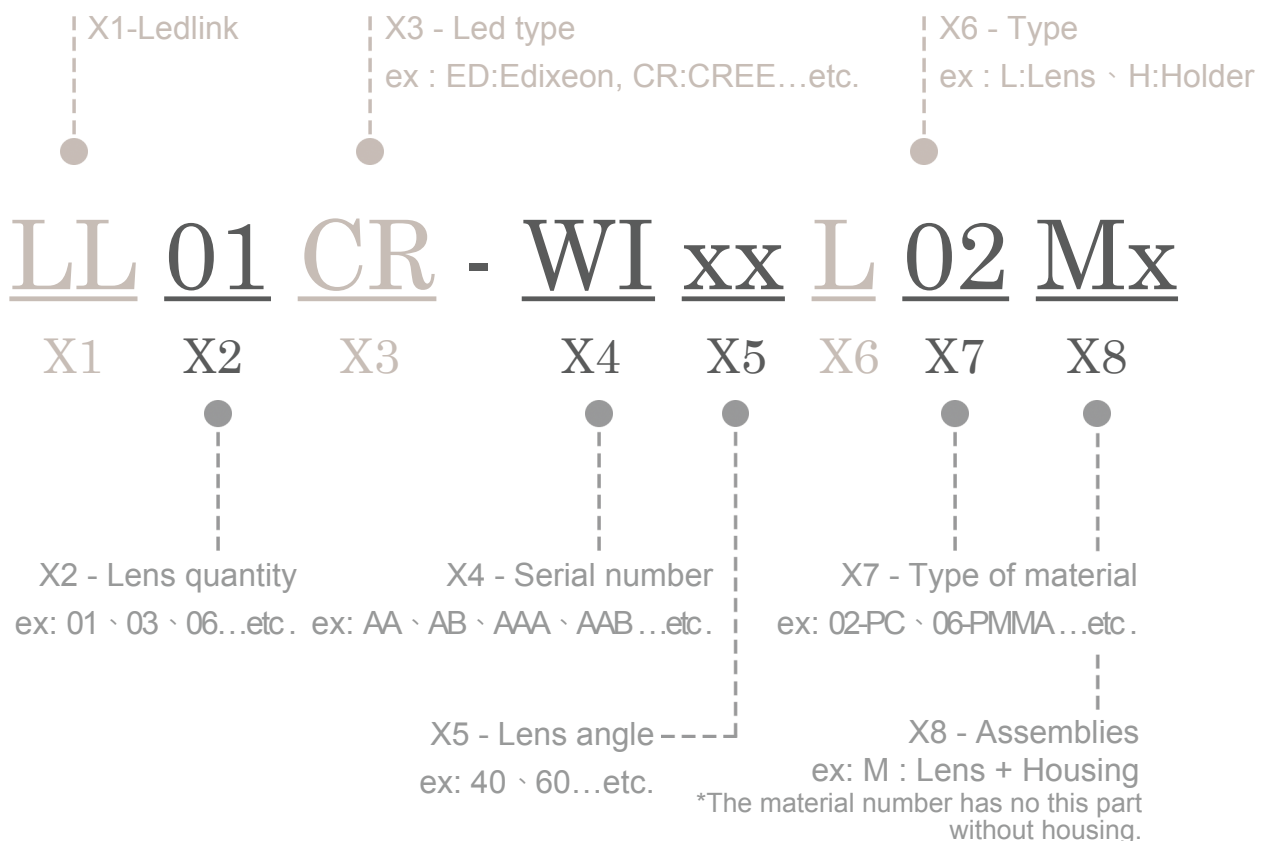



LL01CR-WIxxL02-Mx

Optical Specifications

Xlamp XM-L AWT 

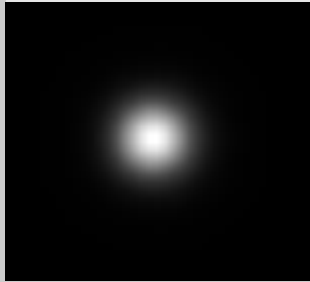
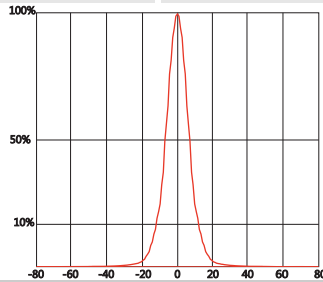
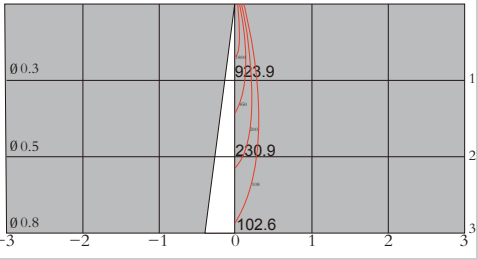
 Note: (1) degree: tolerance $\pm 2^\circ$
 (2) optical value: tolerance $\pm 10\%$

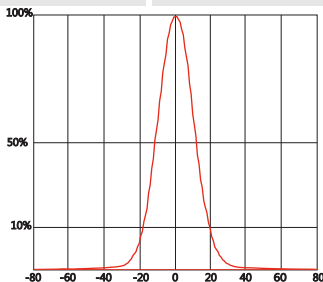
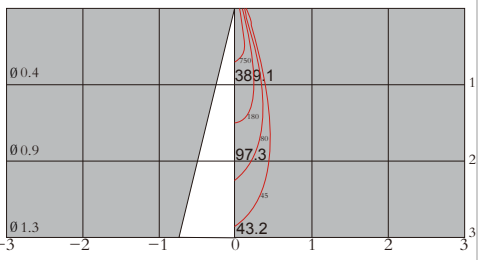
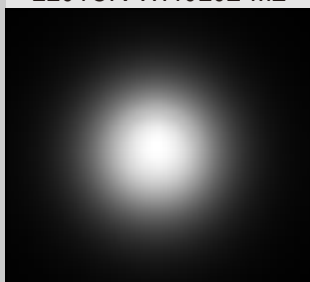
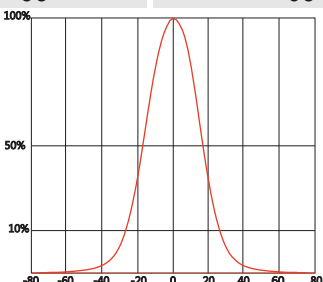
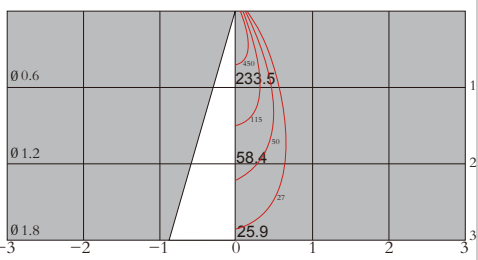
Part Number	FWHM	Field Angle*	cd / lm	IES File
LL01CR-WI15L02-M2	13°	29°	11.8	Download
				
Beam Pattern	Light Distribution Curve		Illuminance Distribution	
LL01CR-WI25L02-M2	26°	49°	3.8	Download
				
Beam Pattern	Light Distribution Curve		Illuminance Distribution	
LL01CR-WI40L02-M2	38°	68°	2.0	Download
				
Beam Pattern	Light Distribution Curve		Illuminance Distribution	

*The Field Angle is the angle between the two directions opposed to each other over the beam axis for which the luminous intensity is 10% that of the maximum luminous intensity.
 *This testing result is obtained through testing the popular rank LED samples which provided by the original manufacturer. Hence, the testing results would be varied as the users choose same LED model but different rank.

LL01CR-WIxxL02-Mx

Mechanical Specification

1. Fixing method

Note: All dimensions are in mm.

Glue

Screw

Tape

Fixing-ring

Frame

2. Lens dimensions

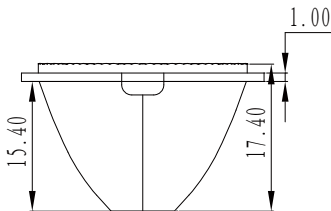
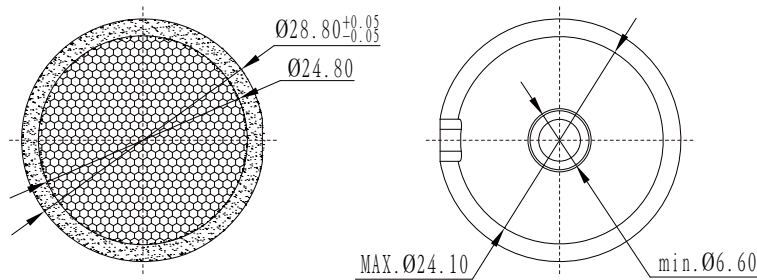

4. Lens assembly dimensions

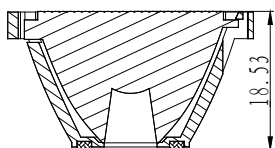
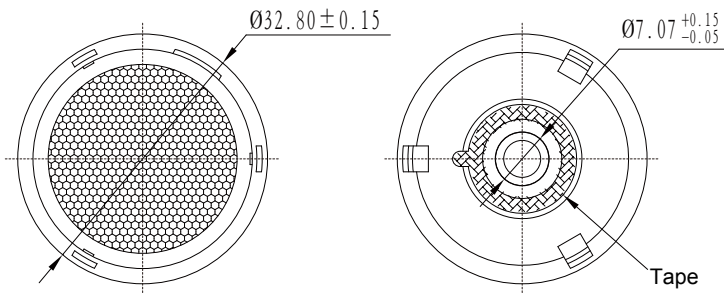

3. Lens + Leds+MCPCB assembly instruction

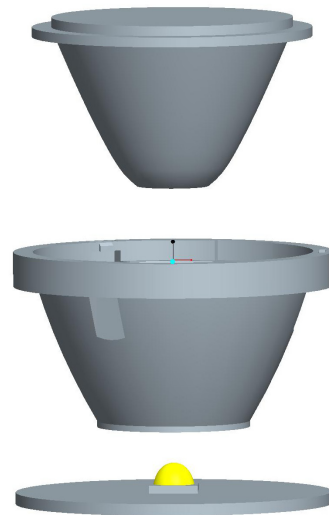

5. View assembly lens with MCPCB:

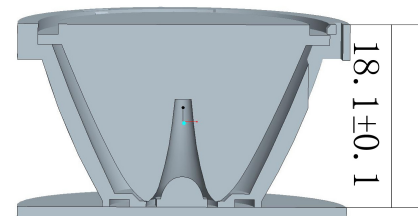

LL01CR-WIxxL02-Mx

Package Specifications

Item	Quantity	Total	Size(L*W*H)	G.W
Inner box	63 pcs /Inner box	63 pcs	33*30*2.1 cm	5.5g
Outer box	504 pcs /Outer box	504 pcs	35*31*21 cm	

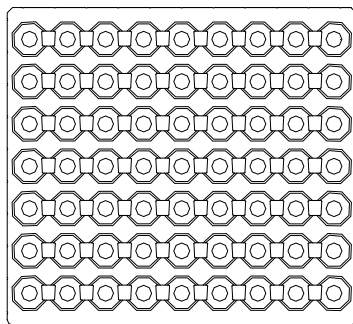

63pcs/Inner box

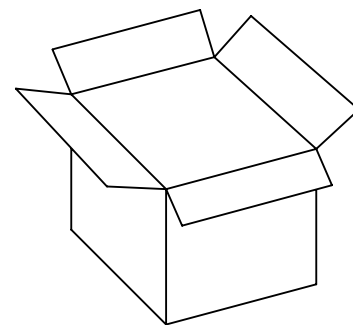
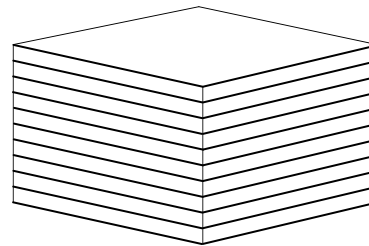

504pcs/Outer box



Note: