

ANTI-VANDALpush button

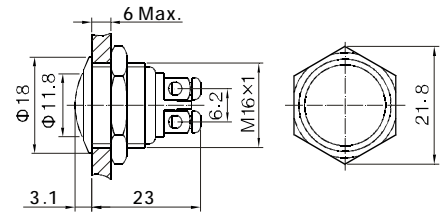

GQ16B

- ⊙ Φ 16mm diameter
- ⊙ Switch Rating:2A/36VDC
- ⊙ Contact Configuration:1NO(1NC Made to order)
- ⊙ Operation Type: Momentary
- ⊙ The Front Shape:Domed
- ⊙ The crust material: Stainless Steel/
Brass(Nickel plated, Gold plated)
- ⊙ IP Degree:IP65



ANTI-VANDALpush button



GQ16F

- ⊙ Φ 16mm diameter
- ⊙ Switch Rating:2A/36VDC
- ⊙ Contact Configuration:1NO(1NC Made to order)
- ⊙ Operation Type: Momentary
- ⊙ The Front Shape:Flat Round
- ⊙ The crust material: Stainless Steel/
Brass(Nickel plated, Gold plated)
- ⊙ IP Degree:IP65

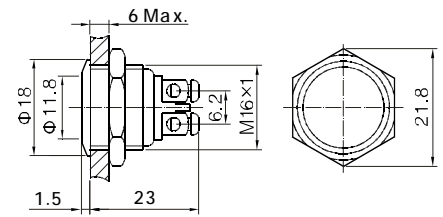

Specification	GQ16B - 10/⊙	GQ16F - 10/⊙	
The Front Shape	Domed	Flat Round	
Terminal Type	Screw Terminals	Screw Terminals	
Switching	No.1	No.1	
Max.Switch Rating	2A/36VDC	2A/36VDC	
Contact Resistance	$\leq 50\text{m}\Omega$	$\leq 50\text{m}\Omega$	
Insulation Resistance	$\geq 1000\text{M}\Omega$	$\geq 1000\text{M}\Omega$	
Dielectric Strength	2000VAC	2000VAC	
Operating Temp	-20°C ~ +55°C	-20°C ~ +55°C	
Mechanical life	1,000,000 cycles	1,000,000 cycles	
Electrical life	200,000 cycles	200,000 cycles	
Panel Thickness	1 ~ 6mm	1 ~ 6mm	
Torque	5 ~ 14Nm	5 ~ 14Nm	
Operation Pressure	About 4N	About 4N	
Operation Distance	About 1.5mm	About 1.5mm	
IP Degree	IP65	IP65	
Material	Contact	Silver Alloy	
	Button	Stainless Steel/Brass(Nickel plated, Gold plated)	
	Body	Stainless Steel/Brass(Nickel plated, Gold plated)	
	Base	PBT	
	RoHS	Made to order	Made to order