

PIERCING PLAN

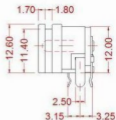

MATE PLUG

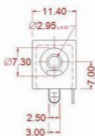

SCHEMATIC



PART NO.	PIN DIA.
DC-3230	Ø2.95mm

DC Power Jack

DC-3230

Type	General Specification	
Electrical	Rating	DC16V @2A
	Contact Resistance	30mV or less
	Insulation Resistance	100MV or more, @ DC 500V
	Dielectric Voltage	AC 500V 50-60Hz, @1minute
Mechanical	Mate Plug	EIAJ & 6.5mm (Outer Diameter)
	Insertion Force	3N~20N
	Withdrawal Force	3N~20N
Durability	Life of Jacks	5,000 cycles (15-18 cycles / minute)
	Operating temperature	-25°C ~ 70°C
	Type of Soldering	Dip Soldering