

REV.	LOCALS	DESCRIPTION	DATE	DRAWN
02	02	add the T-tape reel specifications	12-24-05	PI HONG BIN
03	03	變更料號	2009.03.27	余曉斌

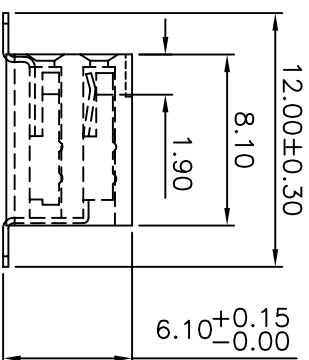
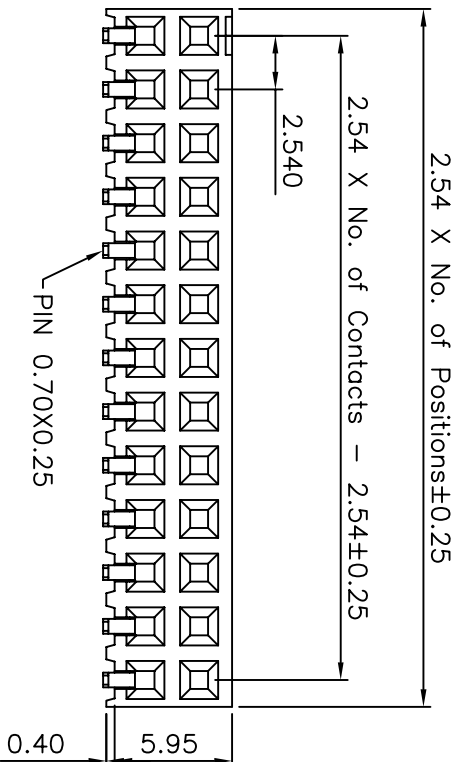
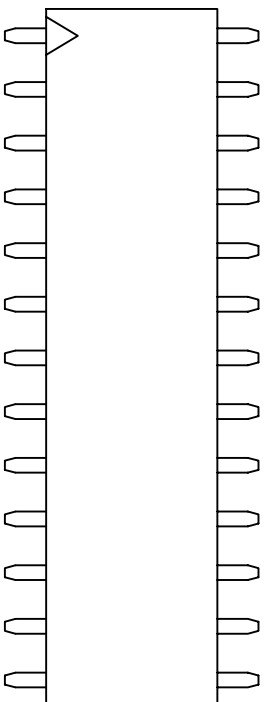

Specifications
 Current Rating: 3Amp
 Insulation Resistance: 1000MΩ Min.
 Dielectric Withstanding: 600V AC/DC
 Contact Resistance: 20mΩ Max.
 Operating Temperature: -40°C to +105°C

Materials

Contact Material: Phosphor Bronze
 Insulation Material: Polyester, UL 94V-0
 Nylon 6T

All materials must meet Greenconn requirement for environment protection

Recommended P.C.Board
 Layout

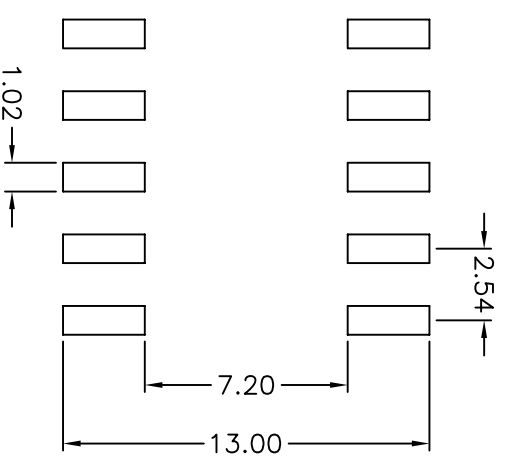

Ordering Information

C SHC210 - XX XX A 001 B 1 A X
 No. of Pins per Row 02~40
 Standard Picking
 02=Gold Flash
 Selective Picking
 01=Tin
 05=Gold Flash/Tin
 Color
 1=Black
 Standard Picking
 C=Tube
 Selective Picking
 A=Box

格 菱 股 份 有 限 公 司
Greenconn Corporation

REV.	UNIT.	SCALE.	GENERAL TOLERANCE	DESIGN:	CHECKED:	AUDITED:	APPROVED:	DATE:	DWG. NO.	PART NO.	TITLE:
03	MM	3:1	X. ± 5° X. ± 3° .XX ± 2° .XXX ± 1°	余曉斌	李新華	LAER	陳東傑	2009.03.27	CSHC210-A001B1AX	CSHC210-XX XXA001B1AX	2.54 FEMALE HEADER DUAL ROWS SMT TYPE SIDE ENTRY