

CIRCUIT DIAGRAM

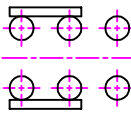

PCB DIMENSION

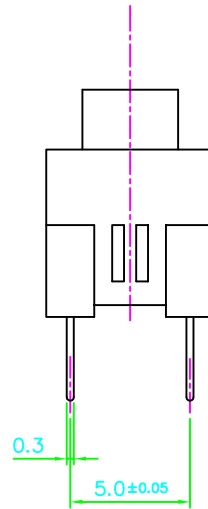
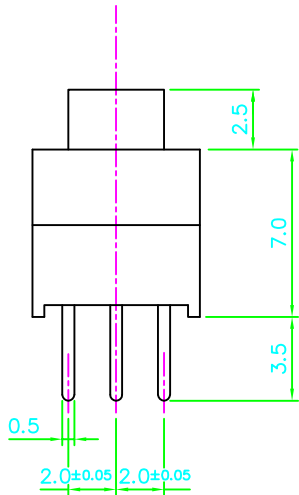
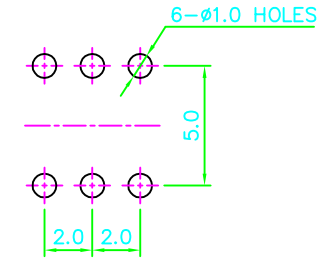

NOTE

1. RATING : DC 30V 0.1A
2. CIRCUIT : 2C - 2P
3. TIMING : NON SHORTING
4. OPERATING FORCE : 200g±50gf
5. STROKE : FULL : 1.8  
LOCK : 1.0
6. OPERATING MODE : SELF LOCK
7. GENERAL TOLERANCE : ±0.3
8. MANUFACTURING SPECIFICATION WOULD BE IN ACCORDANCE WITH HP0101

PART NO		PART NAME		Q'TY	MATERIAL		STANDARD	DISPOSITION	REMARKS
△				TRIGON- OMETRY	UNIT	SCALE 4 / 1	PUSH SWITCH		
△				APPD	CHKD	DSCD			
△							MODEL INP-2212BSA		
△									
NO	.	.	CORRECTION						