

Revisions			
ISS	Symbol	Description	Date
B		CHG for New Drawing Frame & New PN System	2006/07/10

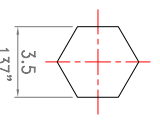
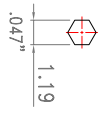
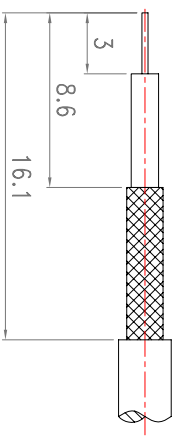
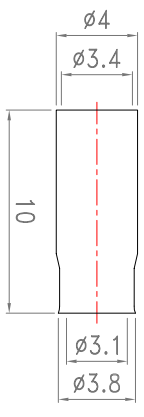
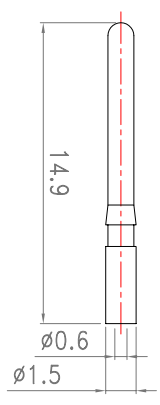
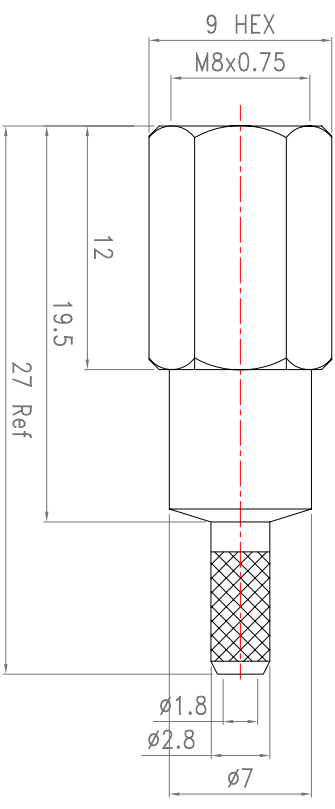

Recommended Cable Stripping Dimm's

Recommended Crimp for Center Pin

Recommended Crimp for Ferrule

ROHS COMPLIANCE

ITEM	Description	Material	Finish	Part Number	QTY
4	Ferrule	Brass	Nickel		
3	Pin	Brass	Gold		
2	Insulator	Delrin	None		
1	Body	Brass	Nickel		

Scale	Abbr.	Date	Rev.
NTS	ST	2007.02.08	B

**Proprietary Note**  
 This document contains information proprietary to S-Comm, which is either copyrighted, or patent applied for, and / or protected by trade secret laws.  
 This document or parts thereof, may not be used, disclosed or reproduced in any form by any method, or for any purpose, without the written permission of S-Comm, Taiwan.  
 Customer P/N: Nil

DWG.NO.	A101B0N02-M
TITLE	FME Crimp Plug for RG174 Cable



S-Comm Enterprise Co., Ltd