

# REELED .250 (6.4) PC QUICK-FIT MALE TERMINALS

Underwriters Laboratories, Inc.  
 Recognized Component Program —  
 UL File Number E201546



UL file number E201546 has been assigned to Keystone Electronics' "Quick-Fit" terminals (Refer to pages 64-68) indicating recognition by Underwriters Laboratories Inc. that they are in compliance with their component program.

Underwriters Laboratories Inc. component program assures that "Quick-Fit" terminals meet the dimensional and performance requirements of the National Electrical Manufacturers Association specification number NEMA2-1982-(1988) and UL310.

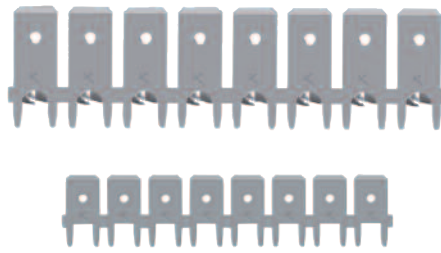
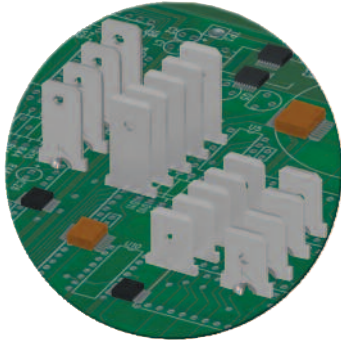

• Supplied in continuous reel for automated pick and place insertion

## .250 (6.4) TAB

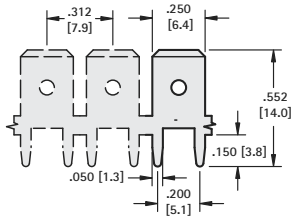

CAT. NO.	MATERIAL	MTG. HOLES
<b>1287-R</b>	.032 (.81) Brass, Tin Plate	.052 (1.3) Dia.

Tape & Reel Spec's: 12,500 per 15 inch reel

## .250 (6.4) TAB

### STURDI-MOUNT

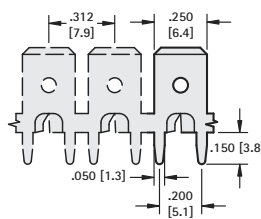

CAT. NO.	MATERIAL	MTG. HOLES
<b>1287-STR</b>	.032 (.81) Brass, Tin Plate	.052 (1.3) Dia.

Tape & Reel Spec's: 15,000 per 24 inch reel

## .250 (6.4) TAB

### STURDI-MOUNT

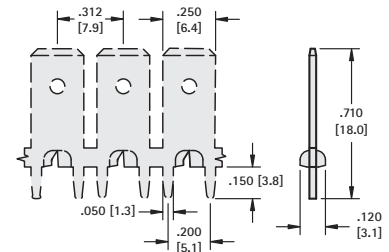

CAT. NO.	MATERIAL	MTG. HOLES
<b>1289-STR</b>	.032 (.81) Brass, Tin Plate	.052 (1.3) Dia.

Tape & Reel Spec's: 15,000 per 24 inch reel

# BULK .250 (6.4) PC QUICK-FIT MALE TABS

## .250 (6.4) TAB

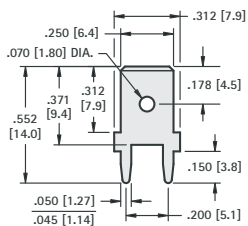

CAT. NO.	MATERIAL	MTG. HOLES
<b>1287</b>	.032 (.81) Brass, Tin Plate	.052 (1.3) Dia.

## .250 (6.4) TAB

### STURDI-MOUNT

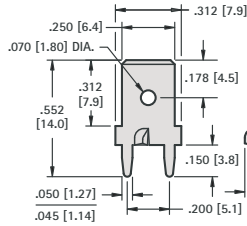
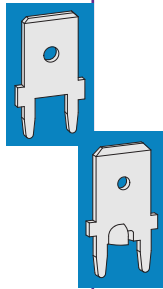

CAT. NO.	MATERIAL	MTG. HOLES
<b>1287-ST</b>	.032 (.81) Brass, Tin Plate	.052 (1.3) Dia.

## .250 (6.4) TAB

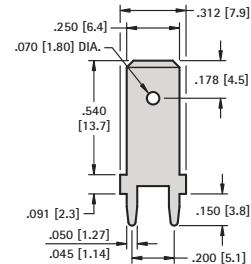

CAT. NO.	MATERIAL	MTG. HOLES
<b>1289</b>	.032 (.81) Brass, Tin Plate	.052 (1.3) Dia.

# SMT .250 (6.4) QUICK-FIT TERMINALS

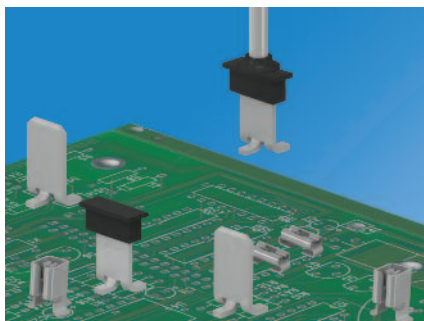

AVAILABLE ON TAPE AND REEL

## .250 (6.4) TAB

### VERTICAL - MALE

- Designed for automated assembly processing
- Available on tape and reel for automated assembly. Pick-up cap added to reeled parts to accommodate vacuum pick and place assembly
- Reflow solder compatible. Plastic pick-up cap will survive reflow temperatures

CAT. NO.	ON TAPE & REEL	MATERIAL
<b>4928*</b>	<b>4928TR*</b>	.032 (.81) Brass, Tin Plate

Tape & Reel Spec's: 16mm wide, 12mm pitch, 13 inch reel (750 pieces per reel)

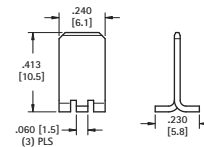

### Mounting Detail

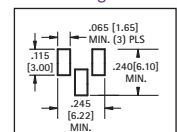

PC QUICK-FIT MALE TERMINALS 

