

SPECIFICATION OF TOROIDAL CORES SERIES

APPLICATIONS

1. The T type ring cores are mainly used for coupling transformers, balancing coils, fixed coils and filter coils.
 2. The RH type bead cores are mainly produced for the cable wire assemblers and MATV CATV makers.
- * Internal and external computer data and power cables



ORDERING CODE

K5B I 3.5 x 3 x 1.5
(1) (2) (3) (4) (5)

- (1) MATERIAL
- (2) PRODUCT CODE
- (3) A DIM.
- (4) B DIM.
- (5) D DIM.

K5B RH 3.5 x 6 x 1.2
(1) (2) (3) (4) (5)

- (1) MATERIAL
- (2) PRODUCT CODE
- (3) A DIM.
- (4) B DIM.
- (5) D DIM.

SHAPE

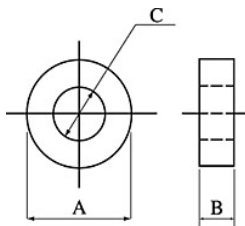

FIG 1

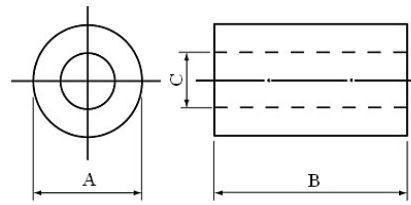
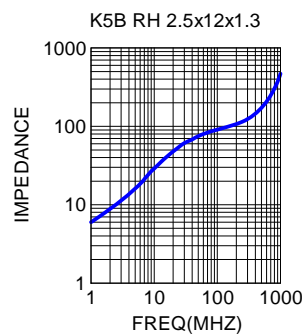
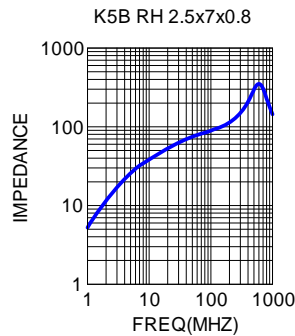
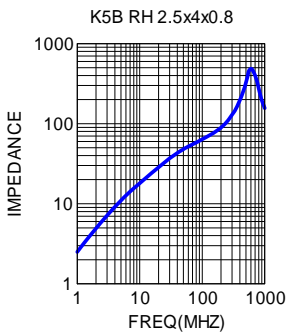

FIG 2

DIMENSIONS & CHARACTERISTICS

UNIT:mm

NO.	ORDERING CODE	A	B	C	Fig
1	RH 2.5x4x0.8	2.50±0.15	4.00±0.30	0.80±0.15	2
2	RH 2.5x7x0.8	2.50±0.15	7.00±0.30	0.80±0.15	2
3	RH 2.5x12x1.3	2.50±0.15	12.00±0.40	1.30±0.15	2



※Other sizes are available upon request.

※All the data listed in this catalogue are for reference only, King Core reserves the right to alter or revise the specifications without prior notification.

SPECIFICATION OF TOROIDAL CORES SERIES

NO.	ORDERING CODE	A	B	C	Fig
4	T 3x2x1	3.00±0.15	2.00±0.20	1.00±0.15	1
5	T 3x2x1.2	3.00±0.15	2.00±0.20	1.20±0.15	1
6	RH 3x3x1	3.00±0.15	3.00±0.20	1.00±0.15	2
7	RH 3x3x1.2	3.00±0.15	3.00±0.20	1.20±0.15	2
8	RH 3x4x1	3.00±0.15	4.00±0.30	1.00±0.15	2
9	RH 3x6x1	3.00±0.15	6.00±0.30	1.00±0.15	2
10	RH 3.4x11.2x1.1	3.40±0.15	11.20±0.40	1.10±0.15	2
11	T 3.5x0.8x1.5	3.50±0.15	0.80±0.20	1.50±0.15	1
12	T 3.5x1.25x1.8	3.50±0.15	1.25±0.20	1.80±0.15	1
13	T 3.5x1.3x1.8	3.50±0.15	1.30±0.20	1.80±0.15	1
14	T 3.5x1.54x1.5	3.50±0.15	1.54±0.20	1.50±0.15	1
15	T 3.5x2x1.2	3.50±0.15	2.00±0.20	1.20±0.15	1
16	T 3.5x2.5x0.8	3.50±0.15	2.50±0.20	0.80±0.15	1
17	T 3.5x3x0.8	3.50±0.15	3.00±0.20	0.80±0.15	1
18	T 3.5x3x1.0	3.50±0.15	3.00±0.20	1.00±0.15	1
19	T 3.5x3x1.2	3.50±0.15	3.00±0.20	1.20±0.15	1
20	T 3.5x3x1.3	3.50±0.15	3.00±0.20	1.30±0.15	1
21	T 3.5x3x1.4	3.50±0.15	3.00±0.20	1.40±0.15	1
22	T 3.5x3x1.5	3.50±0.15	3.00±0.20	1.50±0.15	1
23	T 3.5x3x1.7	3.50±0.15	3.00±0.20	1.70±0.15	1
24	T 3.5x3x1.8	3.50±0.15	3.00±0.20	1.80±0.15	1
25	T 3.5x3.25x1.3	3.50±0.15	3.25±0.20	1.30±0.15	1
26	T 3.5x3.25x1.4	3.50±0.15	3.25±0.20	1.40±0.15	1
27	T 3.5x3.25x1.5	3.50±0.15	3.25±0.20	1.50±0.15	1
28	RH 3.5x3.5x0.8	3.50±0.15	3.50±0.20	0.80±0.15	2
29	RH 3.5x3.5x1.2	3.50±0.15	3.50±0.20	1.20±0.15	2
30	RH 3.5x3.5x1.7	3.50±0.15	3.50±0.20	1.70±0.15	2
31	RH 3.5x3.5x1.8	3.50±0.15	3.50±0.20	1.80±0.15	2
32	RH 3.5x4x1	3.50±0.15	4.00±0.30	1.00±0.15	2
33	RH 3.5x4x1.2	3.50±0.15	4.00±0.30	1.20±0.15	2
34	RH 3.5x4x1.3	3.50±0.15	4.00±0.30	1.30±0.15	2
35	RH 3.5x4x1.5	3.50±0.15	4.00±0.30	1.50±0.15	2
36	RH 3.5x4.5x0.8	3.50±0.15	4.50±0.30	0.80±0.15	2
37	RH 3.5x4.7x0.8	3.50±0.15	4.70±0.30	0.80±0.15	2
38	RH 3.5x5x0.8	3.50±0.15	5.00±0.30	0.80±0.15	2
39	RH 3.5x5x1.2	3.50±0.15	5.00±0.30	1.20±0.15	2
40	RH 3.5x5x1.3	3.50±0.15	5.00±0.30	1.30±0.15	2
41	RH 3.5x5x1.5	3.50±0.15	5.00±0.30	1.50±0.15	2
42	RH 3.5x5x1.8	3.50±0.15	5.00±0.30	1.80±0.15	2
43	RH 3.5x6x0.8	3.50±0.15	6.00±0.30	0.80±0.15	2
44	RH 3.5x6x1	3.50±0.15	6.00±0.30	1.00±0.15	2
45	RH 3.5x6x1.2	3.50±0.15	6.00±0.30	1.20±0.15	2
46	RH 3.5x6x1.3	3.50±0.15	6.00±0.30	1.30±0.15	2
47	RH 3.5x6x1.5	3.50±0.15	6.00±0.30	1.50±0.15	2
48	RH 3.5x6x1.8	3.50±0.15	6.00±0.30	1.80±0.15	2
49	RH 3.5x7x1.2	3.50±0.15	7.00±0.30	1.20±0.15	2
50	RH 3.5x7.5x0.8	3.50±0.15	7.50±0.30	0.80±0.15	2
51	RH 3.5x8x0.8	3.50±0.15	8.00±0.30	0.80±0.15	2
52	RH 3.5x8x1	3.50±0.15	8.00±0.30	1.00±0.15	2
53	RH 3.5x9x0.8	3.50±0.15	9.00±0.30	0.80±0.15	2
54	RH 3.5x9x1.3	3.50±0.15	9.00±0.30	1.30±0.15	2

※Other sizes are available upon request.

※All the data listed in this catalogue are for reference only, King Core reserves the right to alter or revise the specifications without prior notification.

SPECIFICATION OF TOROIDAL CORES SERIES

NO.	ORDERING CODE	A	B	C	Fig
55	RH 3.5x9.5x0.8	3.50±0.15	9.50±0.30	0.80±0.15	2
56	RH 3.5x14x0.8	3.50±0.15	14.00±0.40	0.80±0.15	2
57	T 3.94x2.54x2.29	3.94±0.15	2.54±0.20	2.29±0.15	1

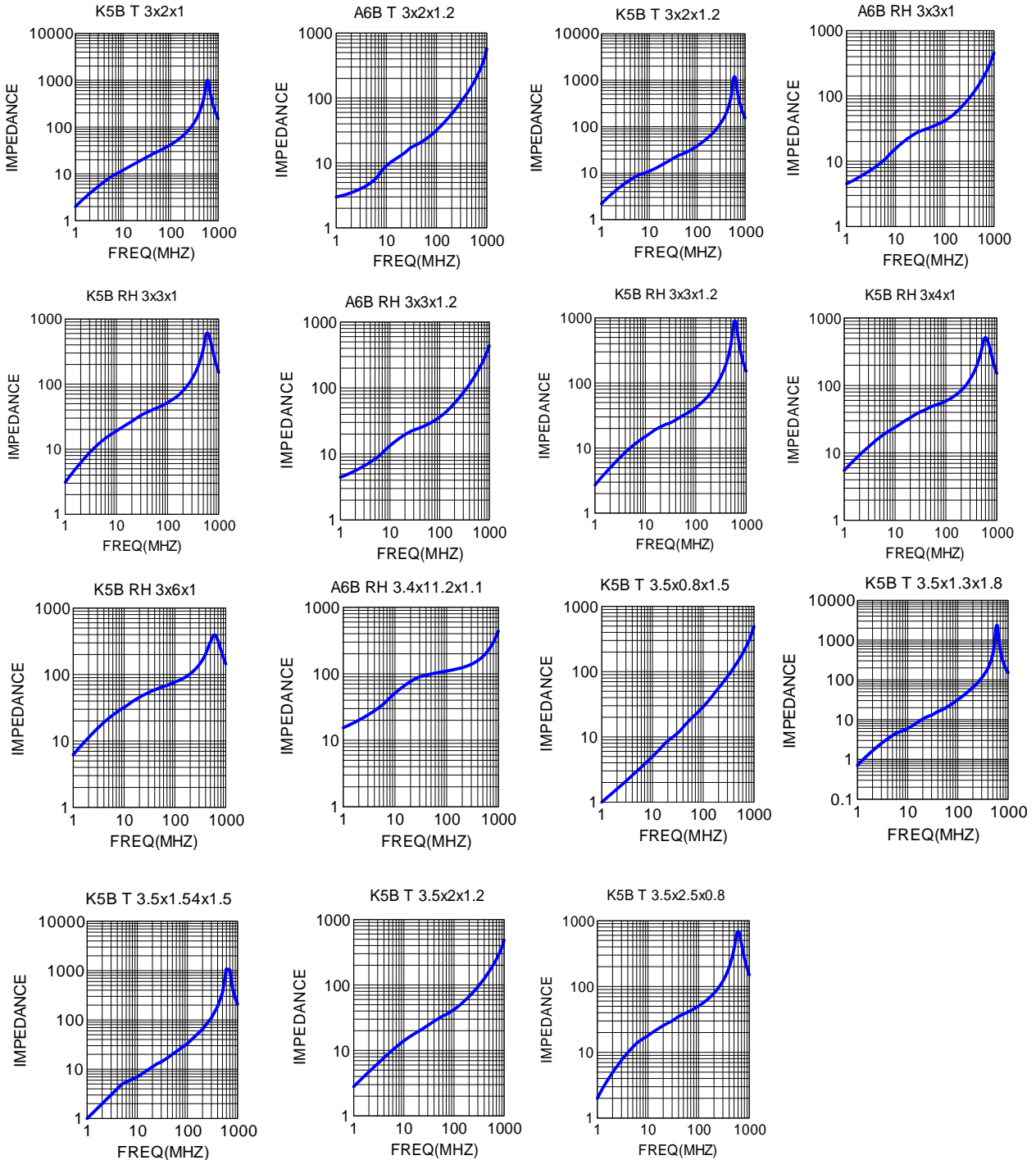

※Other sizes are available upon request.

※All the data listed in this catalogue are for reference only, King Core reserves the right to alter or revise the specifications without prior notification.

SPECIFICATION OF TOROIDAL CORES SERIES

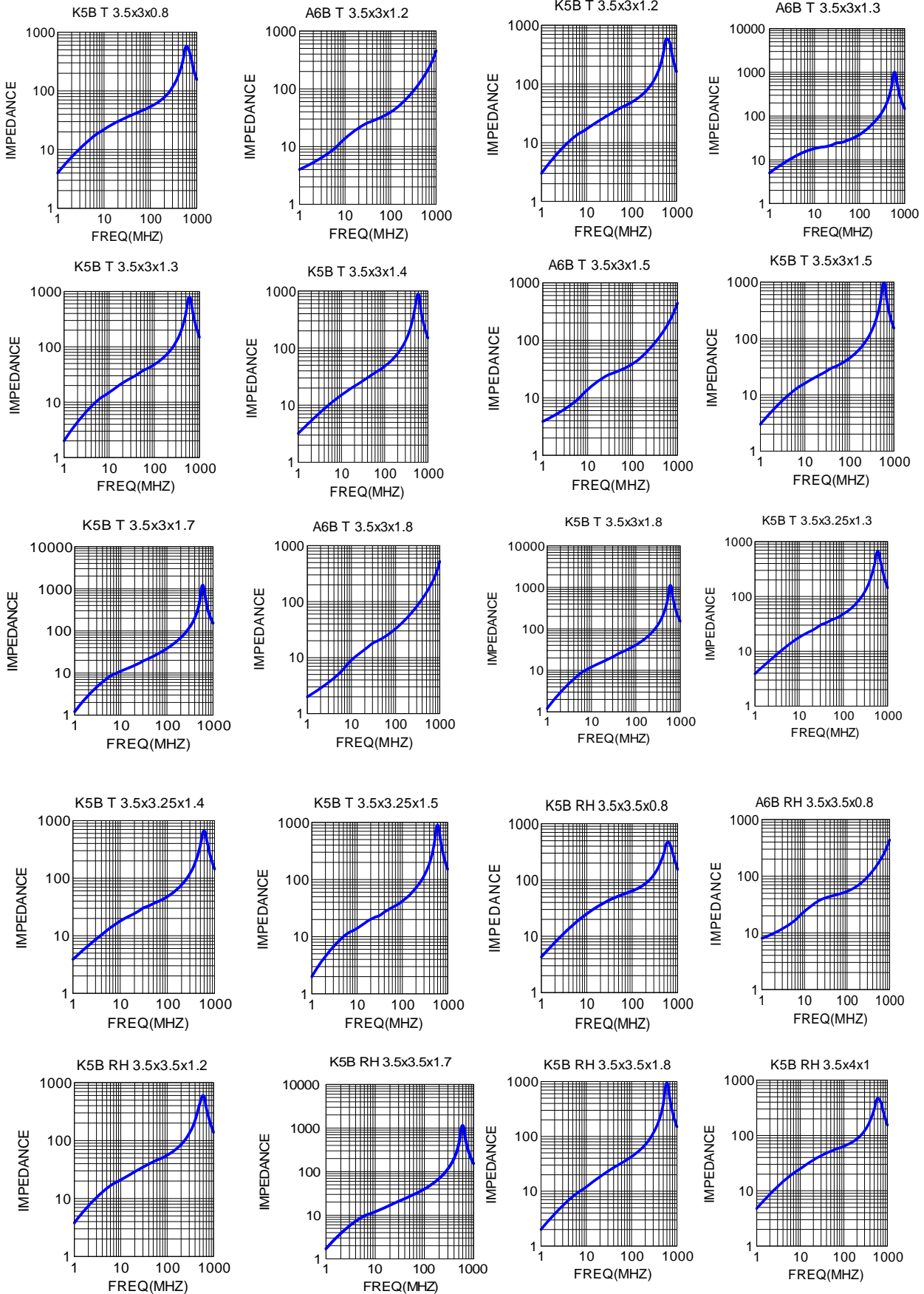

※Other sizes are available upon request.

※All the data listed in this catalogue are for reference only, King Core reserves the right to alter or revise the specifications without prior notification.

SPECIFICATION OF TOROIDAL CORES SERIES

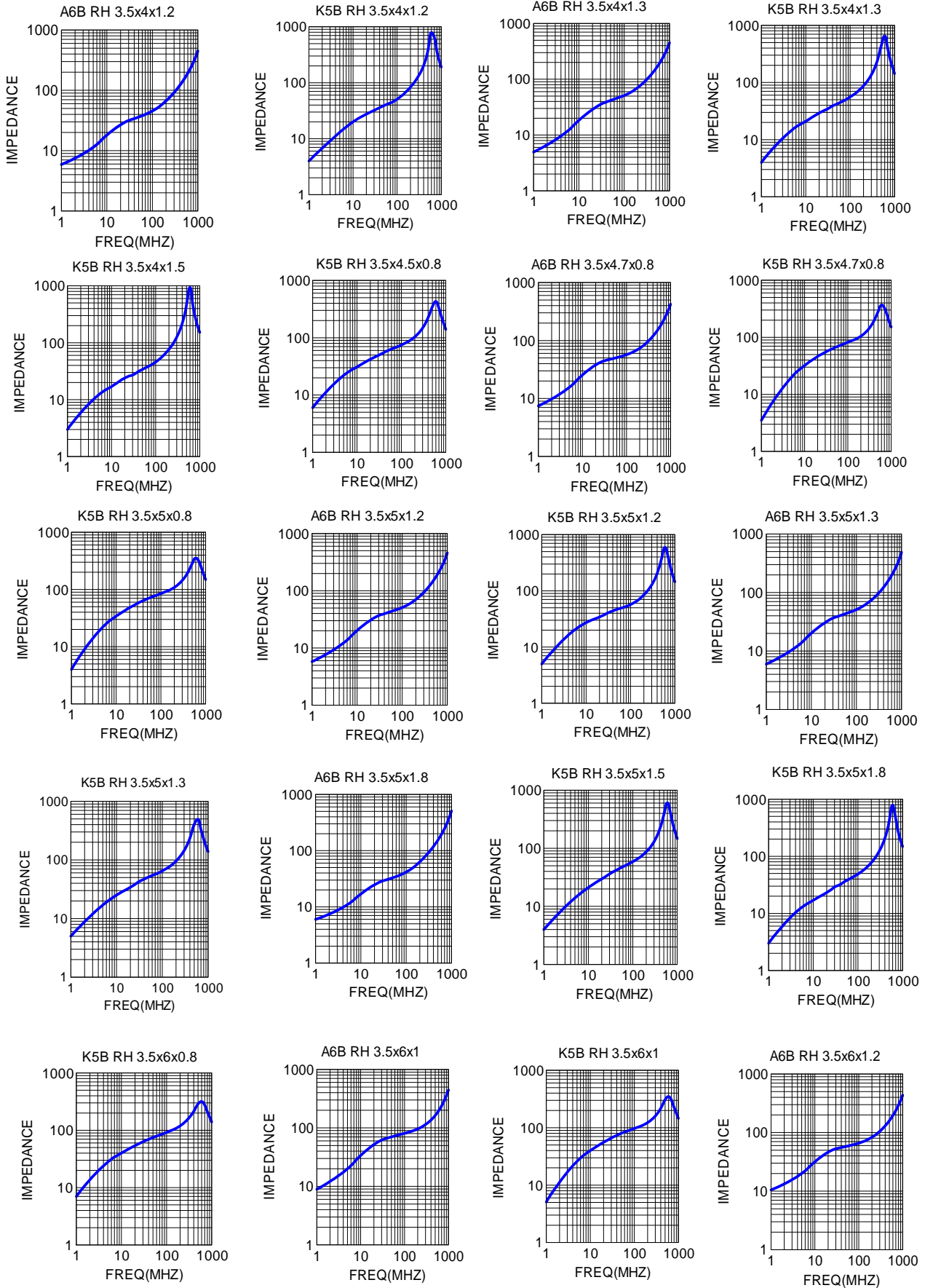

※Other sizes are available upon request.

※All the data listed in this catalogue are for reference only, King Core reserves the right to alter or revise the specifications without prior notification.

SPECIFICATION OF TOROIDAL CORES SERIES

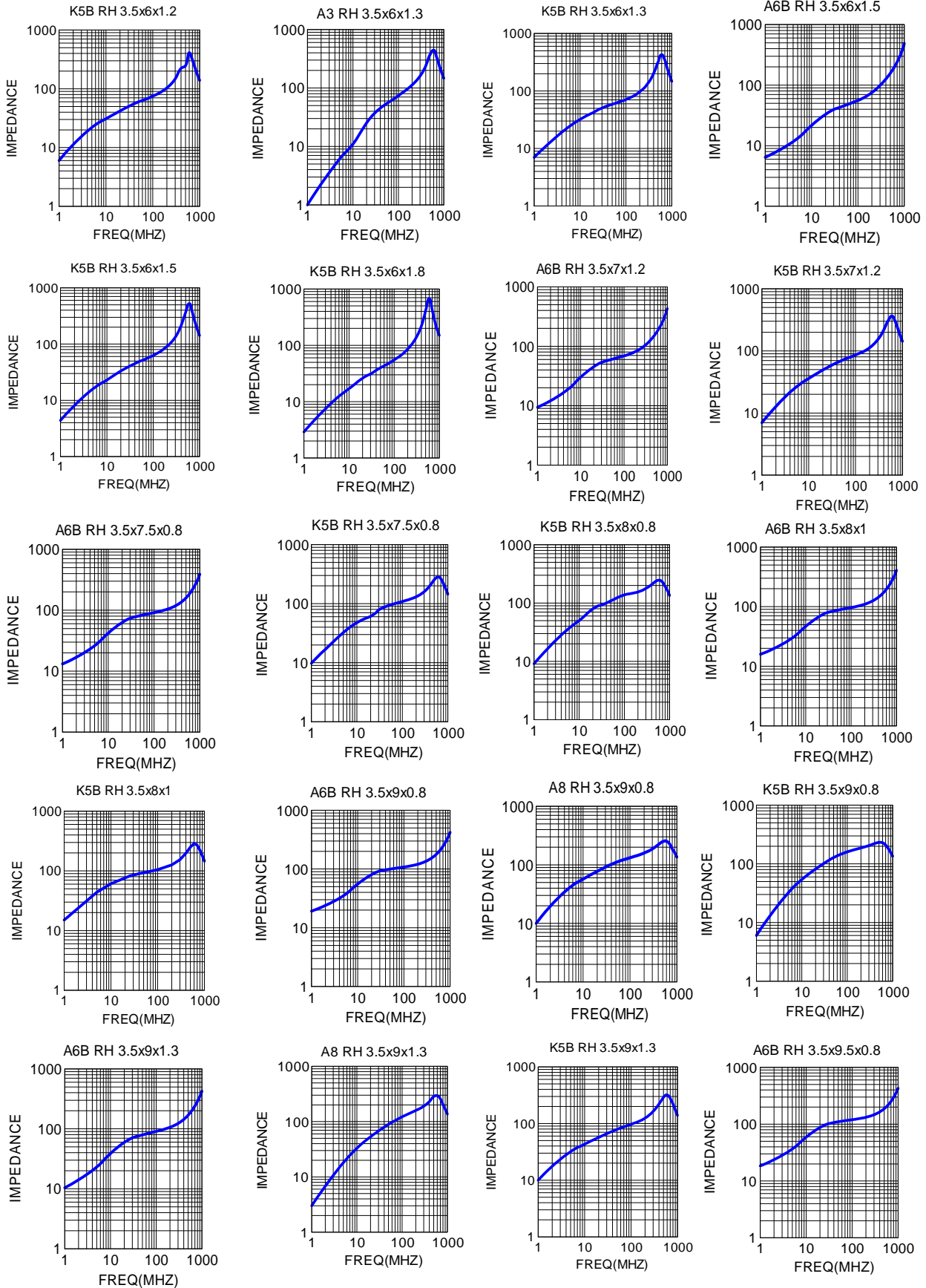

※Other sizes are available upon request.

※All the data listed in this catalogue are for reference only, King Core reserves the right to alter or revise the specifications without prior notification.

SPECIFICATION OF TOROIDAL CORES SERIES

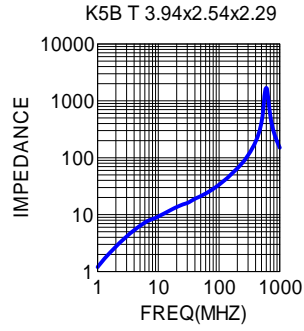
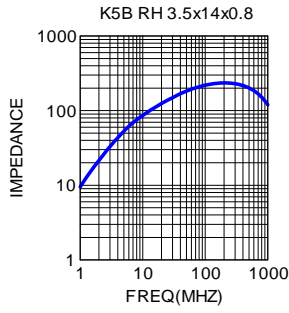
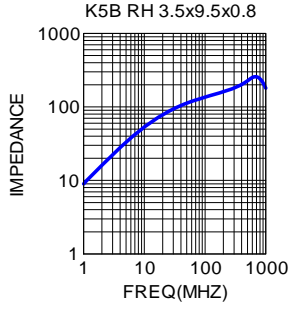

※Other sizes are available upon request.

※All the data listed in this catalogue are for reference only. King Core reserves the right to alter or revise the specifications without prior notification.

SPECIFICATION OF TOROIDAL CORES SERIES

NO.	ORDERING CODE	A	B	C	Fig
58	T 4x1.4x2.2	4.00±0.20	1.40±0.20	2.20±0.15	1
59	T 4x1.5x2	4.00±0.20	1.50±0.20	2.00±0.15	1
60	T 4x1.7x2.2	4.00±0.20	1.70±0.20	2.20±0.15	1
61	T 4x2x1.5	4.00±0.20	2.00±0.20	1.50±0.15	1
62	T 4x2x2	4.00±0.20	2.00±0.20	2.00±0.15	1
63	T 4x3x1.5	4.00±0.20	3.00±0.20	1.50±0.15	1
64	T 4x3x2	4.00±0.20	3.00±0.20	2.00±0.15	1
65	RH 4x4x1.5	4.00±0.20	4.00±0.30	1.50±0.15	2
66	RH 4x4x2	4.00±0.20	4.00±0.30	2.00±0.15	2
67	RH 4x5x1.5	4.00±0.20	5.00±0.30	1.50±0.15	2
68	RH 4x5x2	4.00±0.20	5.00±0.30	2.00±0.15	2
69	RH 4x5.5x1.5	4.00±0.20	5.50±0.30	1.50±0.15	2
70	RH 4x6x2	4.00±0.20	6.00±0.30	2.00±0.15	2
71	RH 4x7x2	4.00±0.20	7.00±0.30	2.00±0.15	2
72	RH 4x8x2	4.00±0.20	8.00±0.30	2.00±0.15	2
73	RH 4x10x1.5	4.00±0.20	10.00±0.40	1.50±0.15	2
74	RH 4x10x2	4.00±0.20	10.00±0.40	2.00±0.15	2
75	RH 4x12x2	4.00±0.20	12.00±0.40	2.00±0.15	2
76	RH 4x12.5x1.5	4.00±0.20	12.50±0.40	1.50±0.15	2
77	T 4.1x4x1.6	4.10±0.20	4.00±0.30	1.60±0.15	1
78	T 4.14x3.2x1.6	4.14±0.20	3.20±0.20	1.60±0.15	1
79	T 4.3x2.5x2.8	4.30±0.20	2.50±0.20	2.80±0.15	1
80	T 4.4x1.4x2.8	4.40±0.20	1.40±0.20	2.80±0.15	1
81	T 4.5x3.2x2.5	4.50±0.20	3.20±0.20	2.50±0.15	1
82	RH 4.5x4.8x2.5	4.50±0.20	4.80±0.30	2.50±0.15	2
83	RH 4.5x7x2.5	4.50±0.20	7.00±0.30	2.50±0.15	2
84	RH 4.5x12x2.6	4.50±0.20	12.00±0.40	2.60±0.15	2
85	RH 4.6x11x2	4.60±0.20	11.00±0.40	2.00±0.15	2
86	RH 4.83x6.35x2.29	4.83±0.20	6.35±0.30	2.29±0.15	2

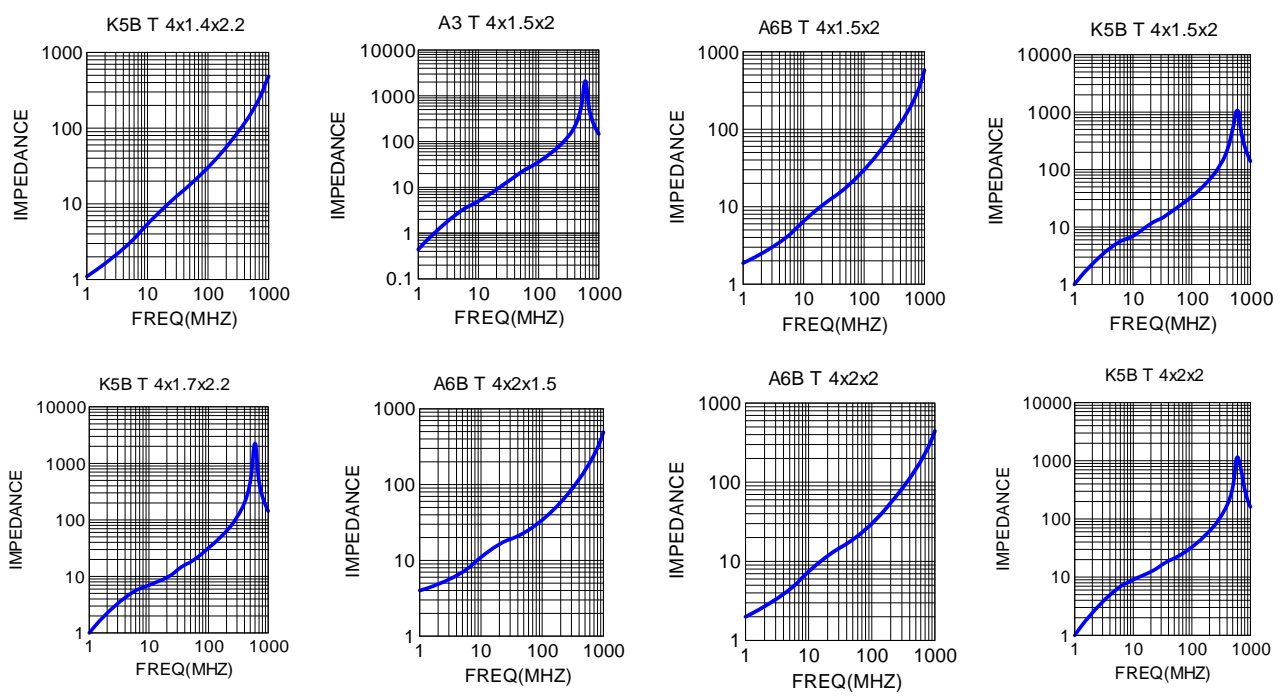

※Other sizes are available upon request.

※All the data listed in this catalogue are for reference only, King Core reserves the right to alter or revise the specifications without prior notification.

SPECIFICATION OF TOROIDAL CORES SERIES

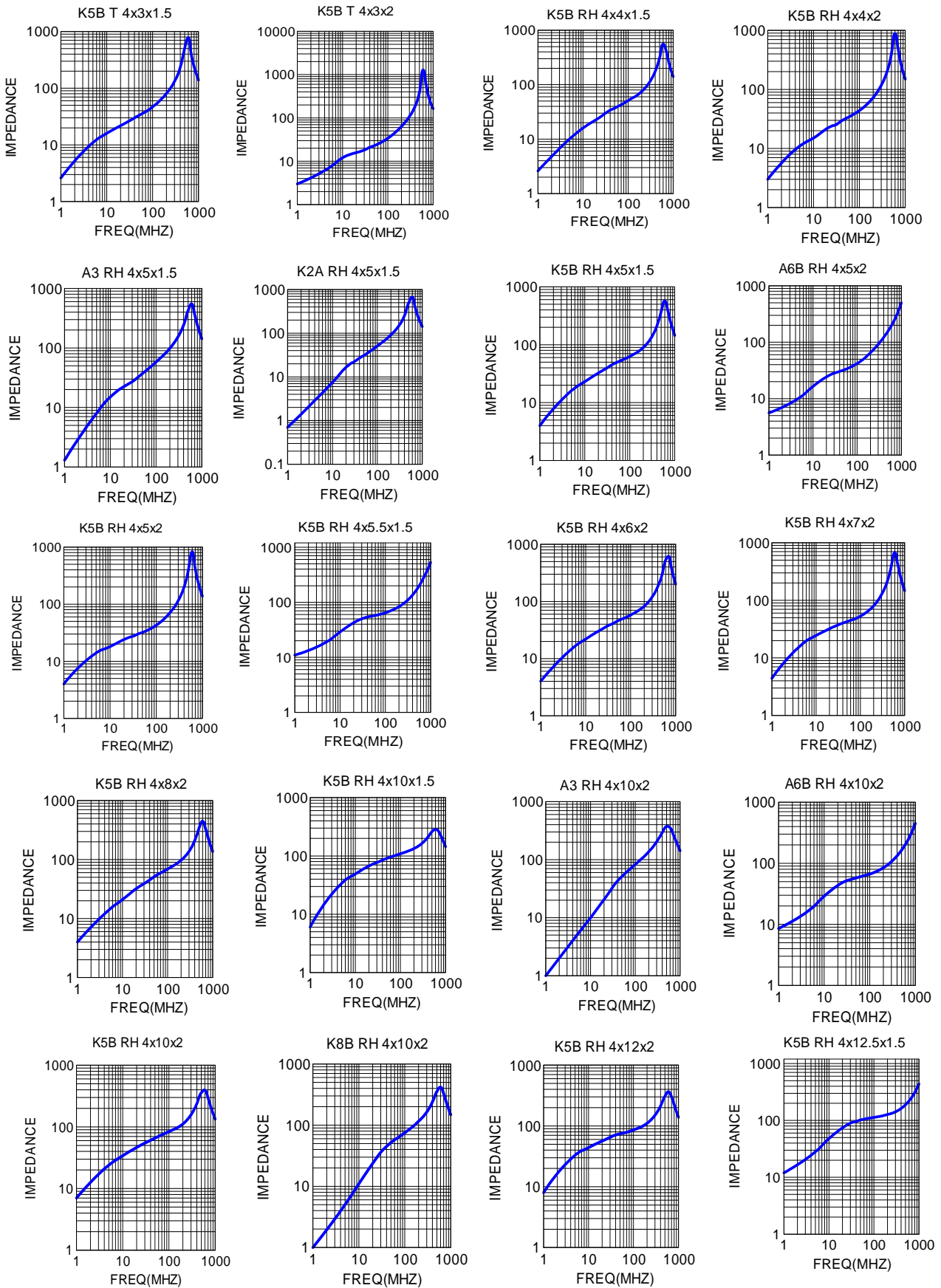

※Other sizes are available upon request.

※All the data listed in this catalogue are for reference only, King Core reserves the right to alter or revise the specifications without prior notification.

SPECIFICATION OF TOROIDAL CORES SERIES

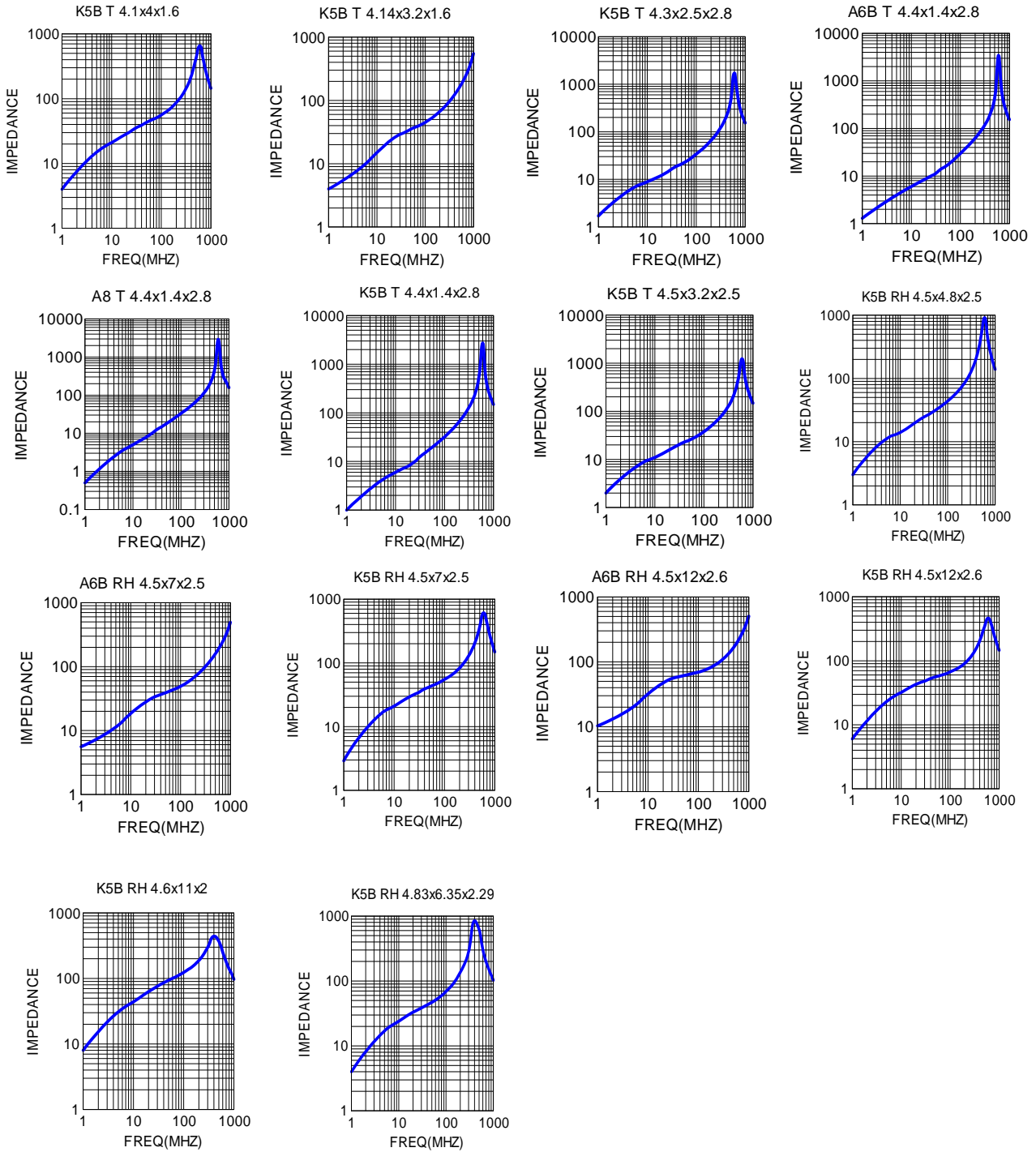

※Other sizes are available upon request.

※All the data listed in this catalogue are for reference only, King Core reserves the right to alter or revise the specifications without prior notification.



KING CORE ELECTRONICS INC.

Tel:886-3-4698855

Fax:886-3-4691395

E-mail:kc@mail.kingcore.com.tw

Web Site: <http://www.kingcore.com.tw>

No.269,Nanfong Rd.,Pingjhen City,Taoyuan County, Taiwan