

A

B

C

D

E

F

REV	DESCRIPTION	DESIGN	DATE
A0	Release	吴丹平	2016.04.30

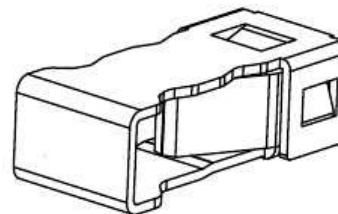
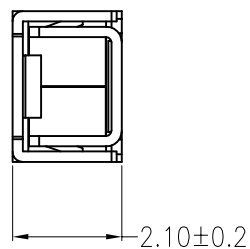
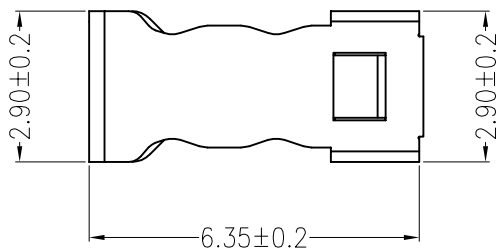

主要技术参数 Main Specifications

线数 (Poles): 01

接触电阻 (Contact resistance): $\leq 20m\Omega$

绝缘电阻 (Insulation resistance): $\geq 800M\Omega$

额定电压 (Rated voltage): 250 V AC DC

额定电流 (Rated current): 2.0A AC DC

耐电压 (Withstand Voltage): 1500V AC/minute

温度范围 (Temperature Range): $-45^{\circ}C \sim +125^{\circ}C$

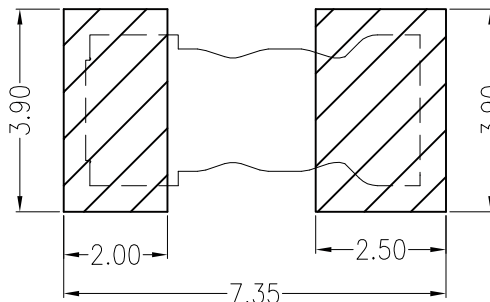
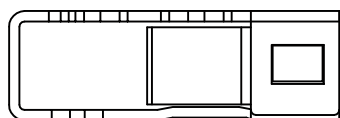

Board Layout

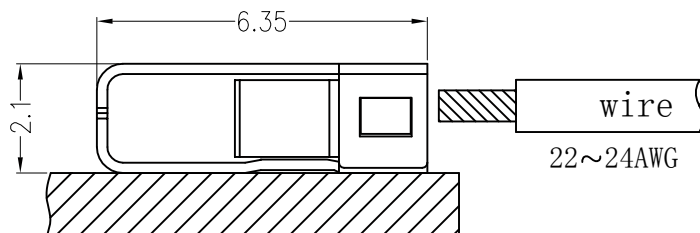

Assembly Layout

C					
B					
A	CONTACT	1 PCS	PhosphorBronze	MATTE Sn-plated	
ITEM	COMPONENT	Q'TY	MATERIAL	FINISH	
LEDsconn					TITLE: --
X.±0.5	X.±5'	USE: CUSTOMER		PART NO.:	
.X±0.3	.X±2'	APPD:		DWG NO.:	
.XX±0.25	.XX±1'	CHKD:		SCALE	
--	--	DR:		1 : 1	SHEET
UNITS: mm				1 / 1	

A

B

C

D

E

F

1

2

3

4

5

1

2

3

4

5