

THIS DOCUMENT IS SUBJECT TO CHANGE WITHOUT NOTICE. IT IS CONFIDENTIAL AND A PROPERTY OF Amphenol LTW. DISCLOSURE TO THIRD PARTY HAS TO BE AUTHORIZED BY Amphenol LTW.

REV.	ECN NO.	DATE	SIGN	DESCRIPTION
D	LEN1681124~135	2016/07/12	Joyy	Modify The Size Of The Red Seal
E	LEN1690117~128	2016/09/10	Joyy	Modify the packaging and quantity
F	LEN1750030~41	2017/04/25	Lingpeng	Add 5Pin

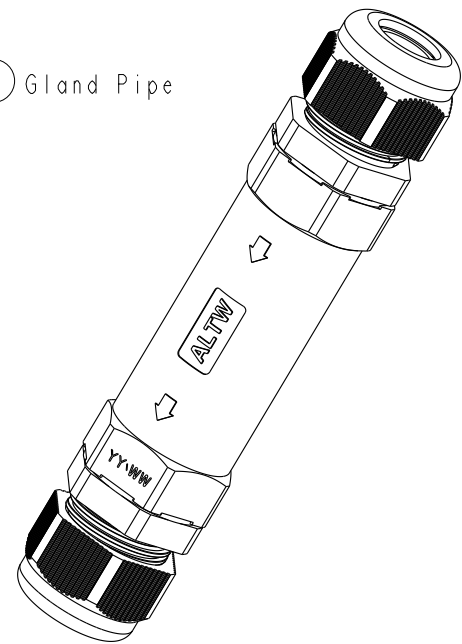
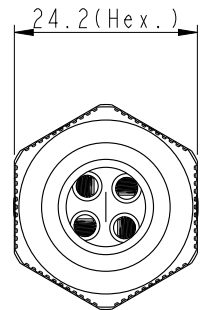
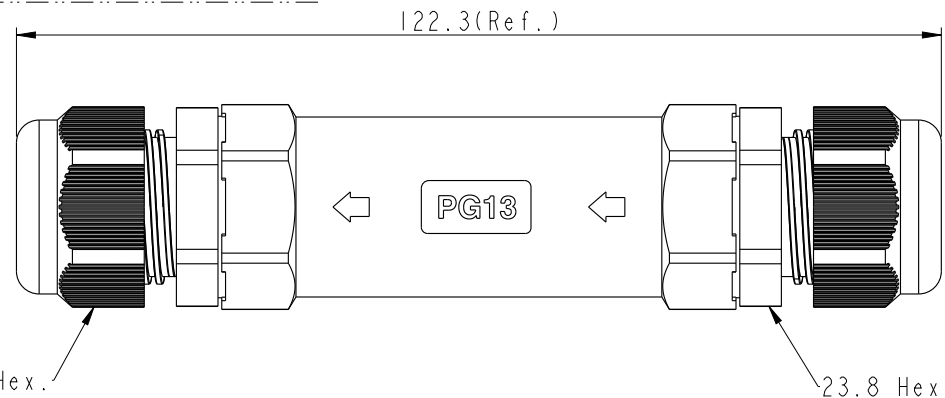
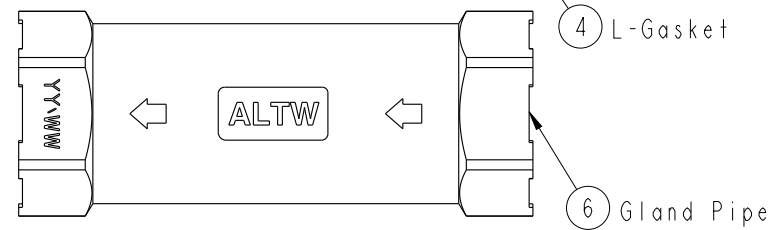
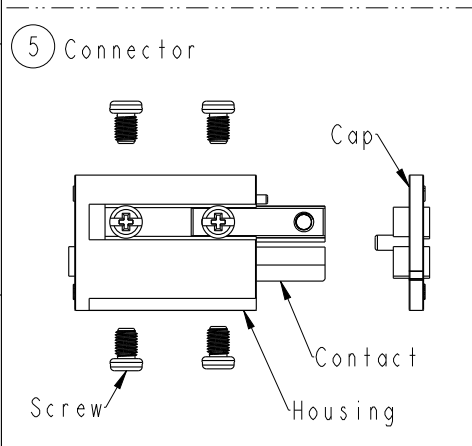
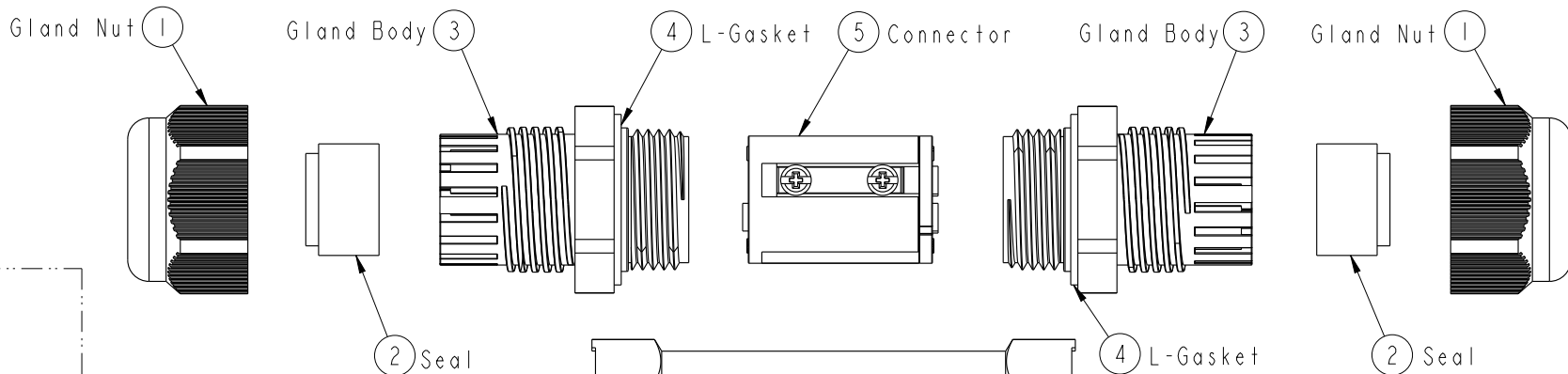

UNIT: mm		
TOLERANCE	.X ±0.25	.XX ±0.1
.XXX ±0.05	ANGLES ±1°	

TITLE PG13 Cable Joiner Screw-in Type		
SCALE 1:1	SIZE A4	SHEET 1 OF 2
REV. F	WC-REV. A.9	Inspection item

Amphenol LTW
安費諾亮泰企業股份有限公司

ITEM NO.	DRAWN BY Lingpeng	DATE 2017-04-25
DWG NO. SC-L-PG13-XX-XX	CHECKED BY Ma Fei	DATE 2017-04-25
CUSTOMER ALTW	APPROVED BY Jerry	DATE 2017-04-25

THIS DOCUMENT IS SUBJECT TO CHANGE WITHOUT NOTICE. IT IS CONFIDENTIAL AND A PROPERTY OF Amphenol LTW. DISCLOSURE TO THIRD PARTY HAS TO BE AUTHORIZED BY Amphenol LTW.

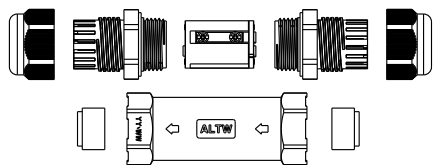

QTY: 1PCS

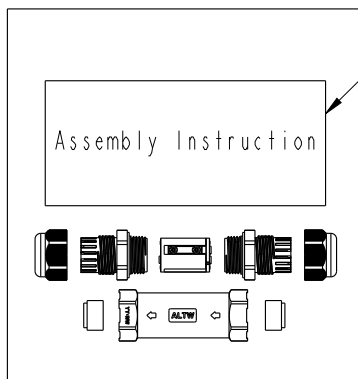
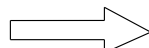

QTY: 105PCS

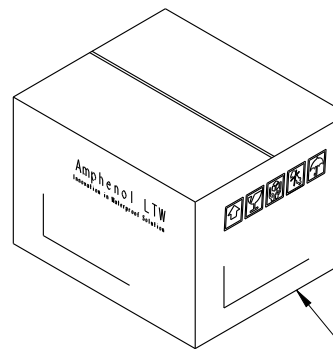
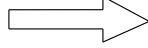

9 Carton

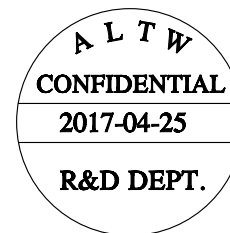

Both A Unassembled product And An Instruction Are In A PE Bag.
(將一套未組裝的產品和說明書, 放置於一個PE袋, 並封口)



Note:

- * \varnothing Important Dimension To Check.
- * Waterproof Rate: IP68 (50M,24H)
- * Housing & Cap: PA66+GF, Black.
- * Gland Pipe: PA66, Black.
- * Gland Body: PA66, Black.
- * Gland Nut: PA6+GF, Black.
- * Contact: Brass, Nickel Plated
- * L-Gasket : Silicone, Yellow.
- * Seal: Silicone, Blue & Yellow & Green & Red.
- * Rated Voltage: 2~5 Pole 450V AC
- * Rated Current: 2 & 3 Pole Max. 20A ,
4 Pole Max. 15A.
5 Pole Max. 8A.
- * Operating Temperature: -40°~+105°
- * Gland Pipe Recommended Tightening Torque:
6~8 Kgf.cm(0.59~0.78 N.m)
- * Gland Nut Recommended Tightening Torque:
6~8 Kgf.cm(0.59~0.78 N.m)
- * Seal For Cable OD: \varnothing 4.5~ \varnothing 6.5mm, Blue.
 \varnothing 6.6~ \varnothing 8.5mm, Yellow.
 \varnothing 8.6~ \varnothing 10.5mm, Green .
 \varnothing 10.6~ \varnothing 11.5mm, Red.
- * Screws for Wire connection recommended tightening torque: 1.29~2.50 kgf.cm / 0.127~0.245 N.m
- * Applicable Wire gauge (Stranded wire cross section) 0.75mm² (18AWG) ~ 2.5mm² (14AWG)

SC-L-PG13-XX-XX
L:Cable Joiner
Type: PG13

Seal's Color: BL-Blue(藍色) For Cable Range: \varnothing 4.5~ \varnothing 6.5mm
YW-Yellow(黃色) For Cable Range: \varnothing 6.6~ \varnothing 8.5mm
GN-Green(綠色) For Cable Range: \varnothing 8.6~ \varnothing 10.5mm
RD-Red(紅色) For Cable Range: \varnothing 10.6~ \varnothing 11.5mm \triangle
No. of Conductor: 02-2Poles
03-3Poles
04-4Poles
05-5Poles

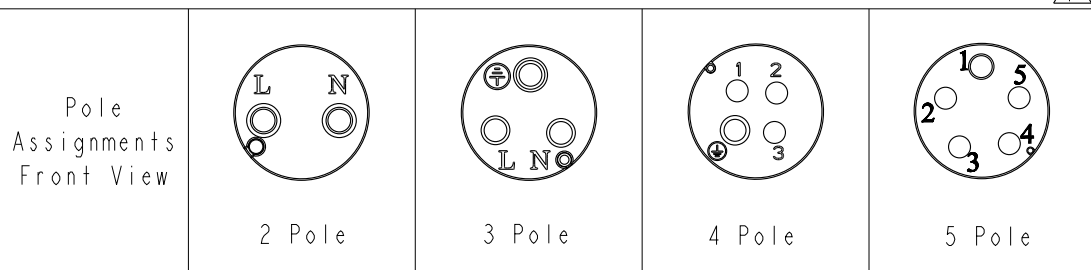

UNIT:mm		TITLE PG13 Cable Joiner Screw-in Type		
TOLERANCE .X ±0.25 .XX ±0.1 .XXX ±0.05 ANGLES ±1°	SCALE 1:1	SIZE A4	SHEET 2 OF 2	
REV. F	WC-REV. A.9	QC: Inspection item		

Amphenol LTW
安費諾亮泰企業股份有限公司

ITEM NO	DRAWN BY Lingpeng	DATE 2017-04-25
DWG NO SC-L-PG13-XX-XX	CHECKED BY Ma Fei	DATE 2017-04-25
CUSTOMER ALTW	APPROVED BY Jerry	DATE 2017-04-25